

Area 5 - I295 SB Structure Mounted Noise Wall
11 feet high
Continues on Figure D1

Area 5 - Ramp F Retaining Wall Mounted Noise Wall
14 - 25 feet high
Continues on Figure D1

Area 8 - Browning Road Ground Mounted Noise Wall Wrap
25 feet high
Continues on Figure D1

Area 7 - Ground Mounted Noise Wall Wrap
25 feet high

Area 7 - Ramp A Structure Mounted Noise Wall
14 feet high
Continues on Figure D1

Area 7 - Ramp E Structure to Ground to Retaining Wall Mounted Noise Wall
15 - 25 feet high

Area 7 - Ramp E Retaining Wall to Ground Mounted Noise Wall
18 - 23 feet high



PROJECT NORTH

KEY MAP

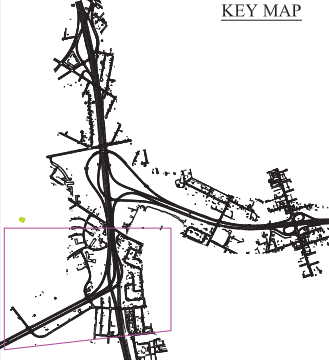

LEGEND

- Proposed Improvement
- Structure Limit
- - - 66 dBA Leq Noise Contour
- Existing Noise Wall Location
- X-X- Removed Existing Noise Wall Location
- Replacement Noise Wall Location
- New Noise Wall Location



New Jersey Department of Transportation

I-295/I-76/Route 42
Direct Connection
Camden County
Figure D2

2030 "Build" with Walls Noise Contour

Date | July 27, 2012

LEGEND

Level of Service C Traffic Conditions

- Category B - Single-Family Structure that Approaches or Exceeds the NAC (66 dBA Leq)
- Category B - Dual-Family Structure that Approaches or Exceeds the NAC (66 dBA Leq)
- Category B - Multi-Family Structure that Approaches or Exceeds the NAC (66 dBA Leq)
- Category B - Special-Use Property (Cemetery or Recreational Area) that Approaches or Exceeds the NAC (66 dBA Leq)

LEGEND

- Category B - Single-Family Structure that Possesses a 10 dBA Leq Increase Over Existing
- Category C - Commercial/Industrial Structure that Approaches or Exceeds the NAC (71 dBA Leq)
- Category E - School/Church Structure that Approaches or Exceeds the NAC, Interior (51 dBA Leq)
- X Structure Acquisition
- * Pump Station

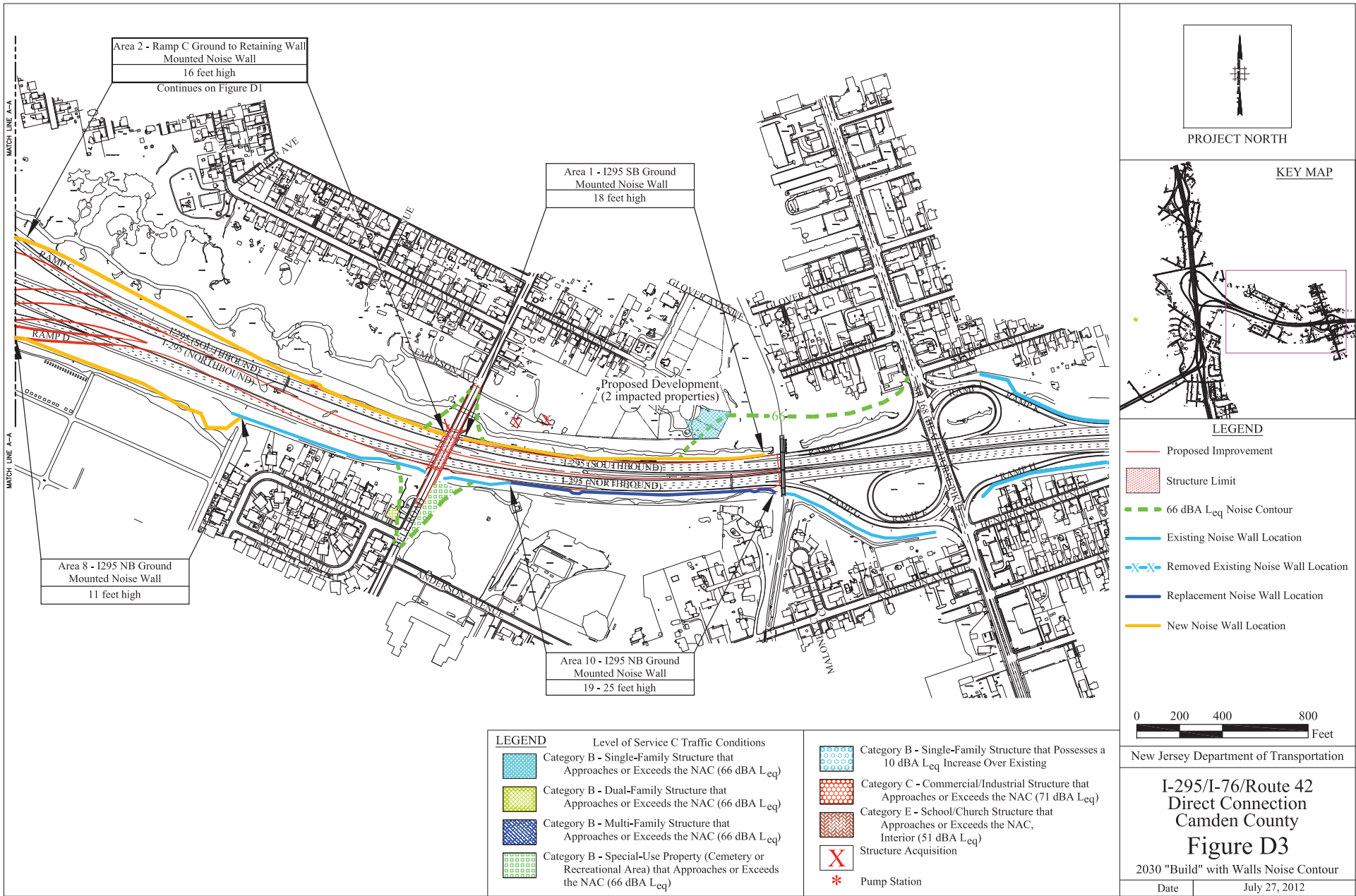

Area 2 - Ramp C Ground to Retaining Wall
Mounted Noise Wall
16 feet high
Continues on Figure D1

Area 1 - I295 SB Ground
Mounted Noise Wall
18 feet high

Proposed Development
(2 impacted properties)

Area 8 - I295 NB Ground
Mounted Noise Wall
11 feet high

Area 10 - I295 NB Ground
Mounted Noise Wall
19 - 25 feet high



PROJECT NORTH

KEY MAP

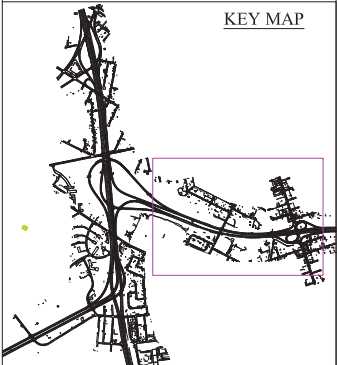

LEGEND

- Proposed Improvement
- Structure Limit
- 66 dBA L_{eq} Noise Contour
- Existing Noise Wall Location
- Removed Existing Noise Wall Location
- Replacement Noise Wall Location
- New Noise Wall Location



New Jersey Department of Transportation

I-295/I-76/Route 42
Direct Connection
Camden County
Figure D3

2030 "Build" with Walls Noise Contour

Date July 27, 2012

LEGEND

Level of Service C Traffic Conditions

- Category B - Single-Family Structure that Approaches or Exceeds the NAC (66 dBA L_{eq})
- Category B - Dual-Family Structure that Approaches or Exceeds the NAC (66 dBA L_{eq})
- Category B - Multi-Family Structure that Approaches or Exceeds the NAC (66 dBA L_{eq})
- Category B - Special-Use Property (Cemetery or Recreational Area) that Approaches or Exceeds the NAC (66 dBA L_{eq})



Category B - Single-Family Structure that Possesses a 10 dBA L_{eq} Increase Over Existing



Category C - Commercial/Industrial Structure that Approaches or Exceeds the NAC (71 dBA L_{eq})



Category E - School/Church Structure that Approaches or Exceeds the NAC, Interior (51 dBA L_{eq})



Structure Acquisition



Pump Station