



REPLY TO
ATTENTION OF

CERTIFIED MAIL- RETURN RECEIPT REQUESTED

DEPARTMENT OF THE ARMY
PHILADELPHIA DISTRICT CORPS OF ENGINEERS
WANAMAKER BUILDING, 100 PENN SQUARE EAST
PHILADELPHIA, PENNSYLVANIA 19107-3390

Regulatory Branch
Application Section II

MAY 15 2019

SUBJECT: CENAP-OP-R-2011-01085-95 (NWP#23)
New Jersey Department of Transportation – Route 295/Route 42 Missing Moves
Project at Big Timber Creek and Delaware River Watershed; Bellmawr and
Runnemede Boroughs in Camden County; and Westville Borough and Deptford
Township in Gloucester County, New Jersey.
Latitude: 39.861506°N, Longitude: -75.115597°W

Ms. Brenna N. Fairfax
New Jersey Department of Transportation
Bureau of Landscape Architecture and Environmental Solutions
P.O. Box 600
Trenton, New Jersey 08625

Dear Ms. Fairfax:

This is in regard to your proposal to construct the Federal Highway Administration-funded roadway improvement project known as “Route 295/Route 42 Missing Moves”; located at Big Timber Creek and the Delaware River Watershed in the Boroughs of Bellmawr and Runnemede in Camden County, and Westville Borough and Deptford Township in Gloucester County, New Jersey.

Under current Federal regulations, a Department of the Army permit is required for work or structures in navigable waters of the United States and/or the discharge of dredged or fill material into waters of the United States including wetlands.

Based upon our review of the information you have provided, it has been determined that your project is approved by the existing Department of the Army Nationwide Permit Number 23 (NWP 23) described below, provided the work is conducted in compliance with the NWP general conditions, regional conditions, and the project specific special conditions.

NWP 23. Approved Categorical Exclusions. Activities undertaken, assisted, authorized, regulated, funded, or financed, in whole or in part, by another Federal agency or department where: (a) That agency or department has determined, pursuant to the Council on Environmental Quality's implementing regulations for the National Environmental Policy Act (40 CFR part 1500 *et seq.*), that the activity is categorically excluded from the requirement to prepare an environmental impact statement or environmental assessment analysis, because it is included within a category of actions which neither individually nor cumulatively have a significant effect on the human environment; and

(b) The Office of the Chief of Engineers (Attn: CECW-CO) has concurred with that agency's or department's determination that the activity is categorically excluded and approved the activity for authorization under NWP 23.

The Office of the Chief of Engineers may require additional conditions, pre-construction notification, for authorization of an agency's categorical exclusions under this NWP.

Notification: Certain categorical exclusions approved for authorization under this NWP require the permittee to submit a pre-construction notification to the district engineer prior to commencing the activity (see general condition 32). The activities that require pre-construction notification are listed in the appropriate Regulatory Guidance Letters.

[Authorities: Section 10 of the Rivers and Harbors Act of 1899 and Section 404 of the Clean Water Act (Sections 10 and 404)]

You are advised that this verification of NWP authorization is valid until the Nationwide Permits expire on **March 18, 2022**, unless the NWP authorization is modified, suspended, or revoked prior to this date. In the event that the NWP authorization is modified during that time period, this expiration date will remain valid, provided the activity complies with any subsequent modification of the NWP authorization.

It is noted that CZM consistency from the State is only required for those activities in or affecting a State's coastal zone. Additionally, some of the NWPs do not involve a discharge of dredged or fill material, and as such, do not require a 401 WQC. If the State has denied the required WQC and/or not concurred with the Corps' CZM consistency determination, the NWP authorization is considered denied without prejudice until an individual project specific WQC and/or CZM approval is obtained.

The State of New Jersey has denied 401 WQC and has not concurred with CZM consistency during the issuance of Philadelphia District's regional conditions for NWP#23. Therefore, you are being directed to seek further review by the state in which they will attach the required Federal consistency determination and certification as part of their review as applicable. This approval must be obtained in order for the activity to be authorized under the NWP and a copy provided to this office before work begins. Any project specific conditions required by the State for the WQC and/or CZM approval will automatically become part of the NWP authorization.

The activities authorized by this NWP verification must comply with the NWP General Conditions, as applicable, in addition to any regional or case-specific conditions imposed by the division engineer or district engineer. A copy of the NWP General Conditions and the Philadelphia District 2017 NWP Regional Permit Conditions for New Jersey for which this verification is subject to, can be found at:

<http://www.nap.usace.army.mil/Portals/39/docs/regulatory/publicnotices/2017%20Nationwide%20Permit%20General%20Conditions.pdf>

http://www.nap.usace.army.mil/Portals/39/docs/regulatory/publicnotices/2017_NJ_Reg_Cond_Final.pdf

In instances where you are unable to access a digital copy of the 2017 NWP General conditions and/or the 2017 NWP Regional Permit Conditions for New Jersey, a hard copy will be transmitted by registered mail to you per request. It is further noted that you may request a copy by email at any time in which the NWP General Conditions and Regional Permit Conditions will be provided to you by facsimile or other electronic means per your request.

Activities which have commenced (i.e., are under construction) or are under contract to commence in reliance upon an NWP will remain authorized provided the activity is completed within twelve months of the date of an NWP's expiration, modification, or revocation, unless discretionary authority has been exercised on a case-by-case basis to modify, suspend, or revoke the authorization in accordance with 33 CFR 330.4(e) and 33 CFR 330.5 (c) or (d). Activities completed under the authorization of an NWP which was in effect at the time the activity was completed continue to be authorized by that NWP.

You should carefully note that this NWP authorization is based upon your agreement to comply with the terms and conditions of this NWP including any and all attached project specific special conditions listed below. Initiation of any authorized work shall constitute your agreement to comply with all of the NWP's conditions. You should also note that the authorized work may be subject to periodic inspections by a representative of this office. The verification of a Nationwide Permit including all general and special conditions is not subject to appeal.

PROJECT SPECIFIC SPECIAL CONDITIONS:

1. All work performed in association with the above noted project shall be conducted in accordance with the attached project plans identified as E-1 through E-41, all dated 06 May 2019, and all prepared by Dewberry.
2. Construction activities shall not result in the permanent disturbance or alteration of greater than 0.670-acres of waters of the United States.
3. Any deviation in construction methodology or project design from that shown on the above noted drawings or repair plan must be approved by this office, in writing, prior to performance of the work. All modifications to the above noted project plans shall be approved, in writing, by this office. No work shall be performed prior to written approval of this office.
4. This office shall be notified prior to the commencement of authorized work by completing and signing the enclosed Notification/ Certification of Work Commencement Form (Enclosure 1). This office shall also be notified within 10 days of the completion of the authorized work by completing and signing the enclosed Notification/Certification of Work Completion/Compliance Form (Enclosure 2). All notifications required by this condition shall be in writing. The Notification of Commencement of work may be sent to this office by facsimile or other electronic means; all other notification shall be transmitted to this office by registered mail. Oral notifications are not acceptable. Similar notification is required each time maintenance work is to be done under the terms of this Corps of Engineers permit.

5. The permittee understands and agrees that, if future operations by the United States require the removal, relocation, or other alteration, of the structure or work herein authorized, or if, in the opinion of the Secretary of the Army or his authorized representative, said structure or work shall cause unreasonable obstruction to the free navigation of the navigable waters, the permittee will be required, upon due notice from the Corps of Engineers, to remove, relocate, or alter the structural work or obstructions caused thereby, without expense to the United States. No claim shall be made against the United States on account of any such removal or alteration.

6. In accordance with New Jersey Regional Permit Condition – 6 (G-6), to protect Essential Fish Habitat (EFH) species, their prey species, and/or their habitats, **in-water work shall NOT be performed between 01 March and 30 June of any given calendar year.** However, work within cofferdams that fully enclose and dewater the project area can proceed any time during the year provided that the cofferdams area installed or removed outside of the seasonal work restriction window and do not preclude the free movement of migrating and spawning aquatic species to ensure compliance with NWP General Conditions #2 and #3.

7. To compensate for the permanent loss of approximately 0.670-acres of Waters of the U.S., the permittee has volunteered to purchase mitigation credits at a 1:1 ratio from the Abbott Creek Mitigation Bank located in the Township of Fairfield in Cumberland County, New Jersey. The permittee shall provide this office with written proof of purchase of the required mitigation credits thirty (30) days prior to undertaking any in-water work.

8. Upon conclusion of project construction activities, the permittee shall restore all temporarily impacted Waters of the U.S., to include the removal of temporary fill material, to pre-construction conditions.

Also enclosed is a pre-addressed postal card (Enclosure 3) soliciting your comments on the processing of your application. Any comments, positive or otherwise, on the procedures, timeliness, fairness, etc., may be made on this card. If you should have any questions regarding this matter, please contact Mr. Robert Youhas of my staff at 215-656-6729 or write to the above address.

Sincerely,

for Edward E. Bonner
Chief, Regulatory Branch

Enclosures

PROJECT PLANS

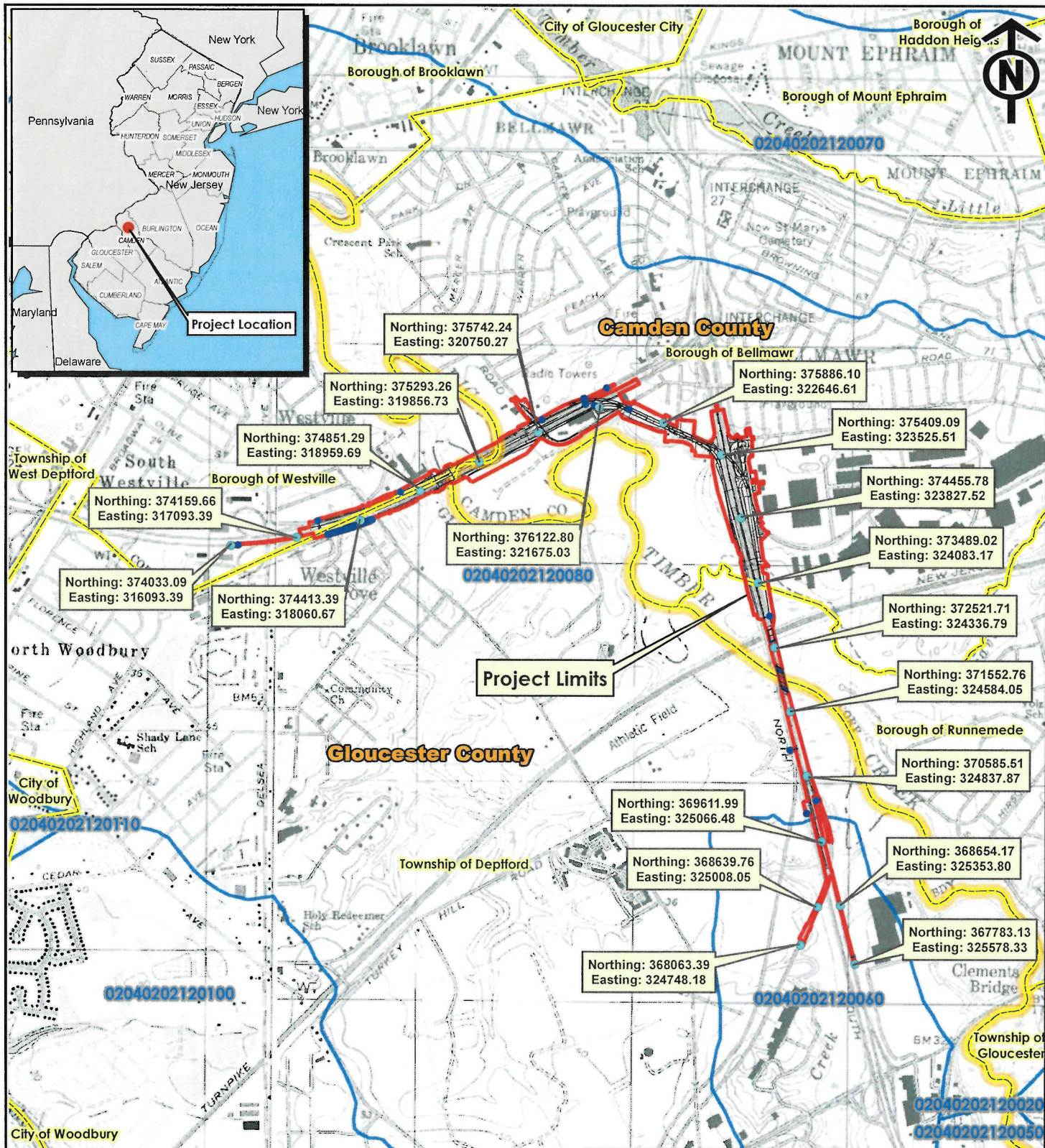

LEGEND

- Limit of Disturbance
- Municipal Boundary
- County Boundary
- Proposed Alignment
- 1000-Foot Intervals
- HUC-14



NEW JERSEY DEPARTMENT OF TRANSPORTATION

USGS SITE LOCATION MAP

I-295 / ROUTE 42 MISSING MOVES
 BOROUGH OF BELLMAWR, BOROUGH OF RUNNEMEDE,
 CAMDEN COUNTY, NJ
 BOROUGH OF WESTVILLE, TOWNSHIP OF DEPTFORD,
 GLOUCESTER COUNTY, NJ

SCALE: As Indicated DATE: March 2019

Source: U.S.G.S. Topographic Quadrangles. Camden, Runnemede, Philadelphia & Woodbury N.J.-P.A.. Dated HUC-14, Department of Environmental Protection (NJDEP), New Jersey Geological Survey (NJGS), 2011



FIGURE 1

MAY 06 2019

E-1

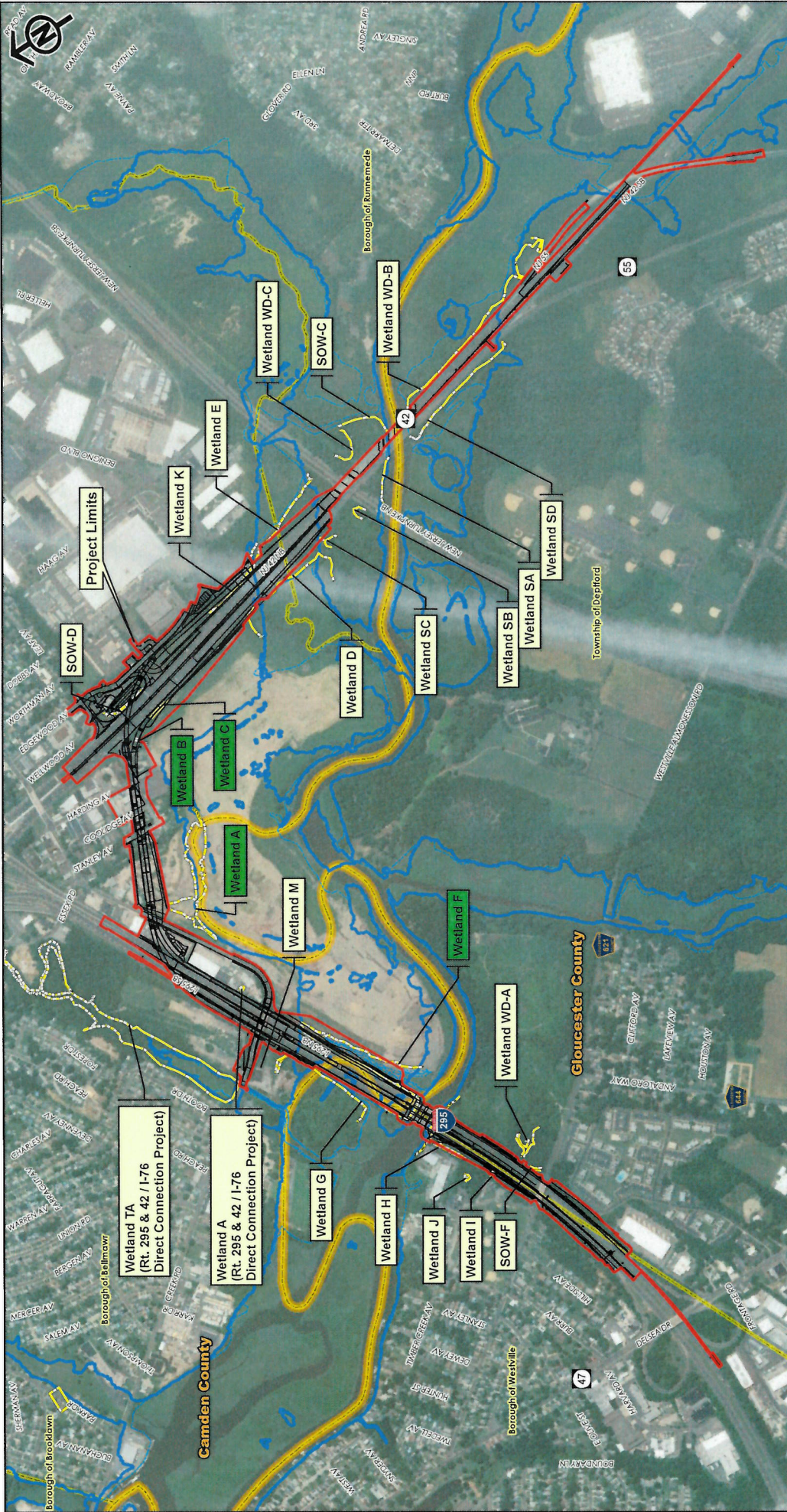

NEW JERSEY DEPARTMENT OF TRANSPORTATION

DELINEATED WETLANDS MAP
 I-295 / ROUTE 42 MISSING MOVES
 BOROUGH OF BELLMAR, BOROUGH OF RUNNEMEDE,
 CAMDEN COUNTY, NJ
 BOROUGH OF WESTVILLE, TOWNSHIP OF DEPTFORD,
 GLOUCESTER COUNTY, NJ
 SCALE: As Indicated DATE: March 2019

Dewberry

FIGURE 2

LEGEND

- Limit of Disturbance
- Proposed Alignment
- Upper Wetland Boundary
- Delineated Wetlands
- Filled Wetland - USACE & NJDEP Permits
- Tidelands Claim Line

Sources: World Office Insects, Seals, ESI
 The information on this plan is based on a compilation of publicly available
 New Jersey Department of Environmental Protection (NJDEP) Geographic
 Information System geospatial data and visual reconnaissance of the vicinity.
 No verification or approval by NJDEP of the information presented is implied.
 Path: G:\19598\Technical\GIS\Common\2014\2e\wv\011\19598\2018\Esc_600_Del_Vet_Map.mxd

MAY 06 2019

E-2

STATE OF NEW JERSEY
 N.J.
 HPP-2551 (10/1)

BOROUGH OF BELLMAR
 BOROUGH OF RUNNEMEDE
 CAMDEN COUNTY

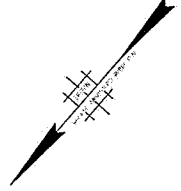
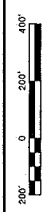

TOWNSHIP OF DEPTFORD
 GLOUCESTER COUNTY

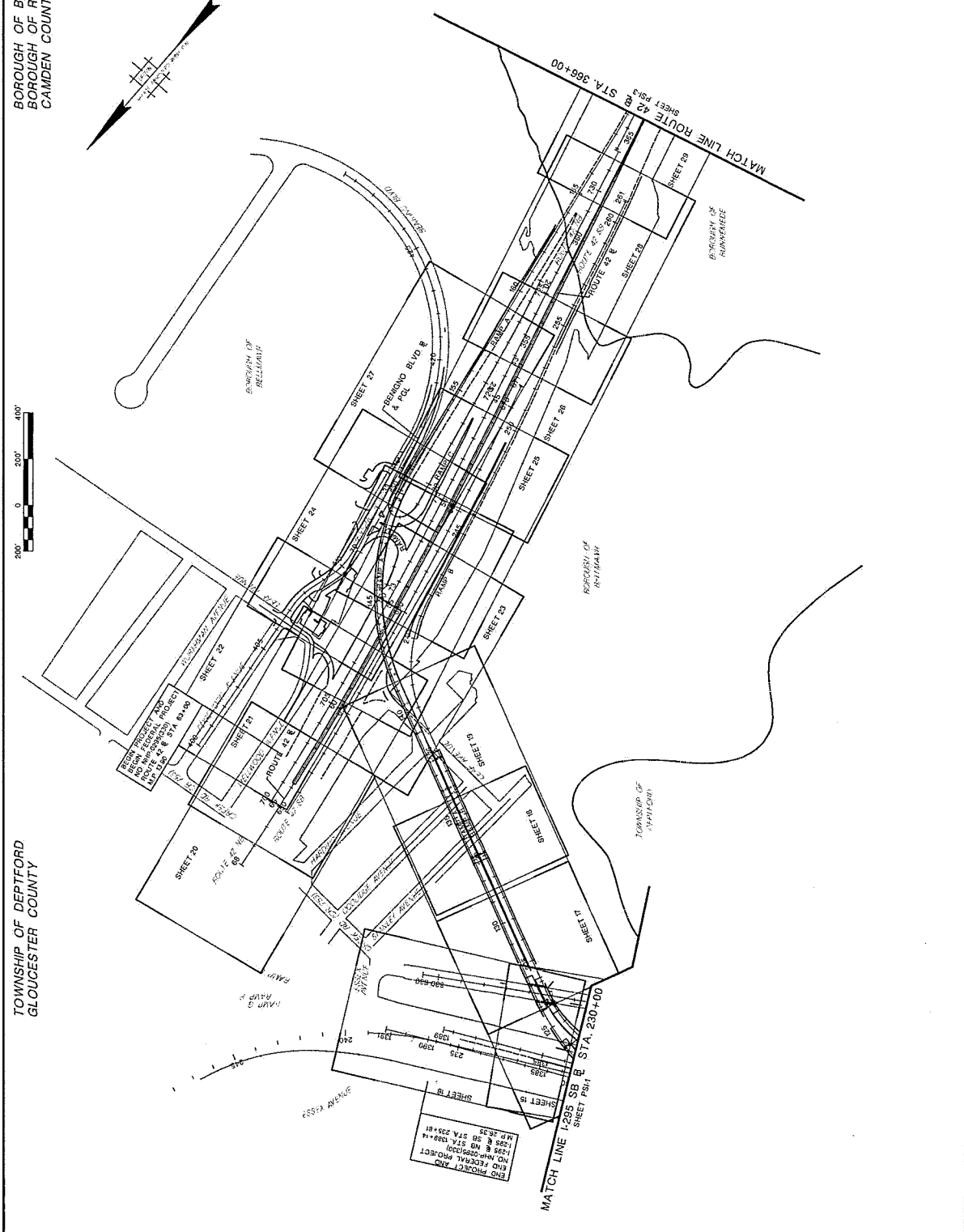

END PROJECT AND
 REVERT PROJECT
 TO ORIGINAL
 OWNER
 M.F.S. STA. 200+00
 M.F.S. STA. 200+00

MATCH LINE 1+395 SB B STA. 200+00
 SHEET PS1 B

MATCH LINE ROUTE 42 B STA. 369+00
 SHEET PS1 B

NEW JERSEY DEPARTMENT OF TRANSPORTATION

PLAN SHEET INDEX
 I-295 / ROUTE 42 MISSING MOVES
 CONTRACT NO. 028505H1

COURTESY: HUNTERS, INC.
 CERTIFICATION OF AUTHORIZATION NO. 240404260
 JAMES S. HELEN, P.E.
 NEW JERSEY PROFESSIONAL ENGINEER LICENSE NO. JAG684000

17720071 CAD/Map/Plan/Sheet/Sheet PS1 B STA. 200+00 - July 15, 2013



E-5

MAY 06 2019

STATE LICENSE PROJECT NO.
N.J. RPP19051 (10)

BOROUGH OF BELLMAWR
BOROUGH OF RUNNEMEDE
CAMDEN COUNTY

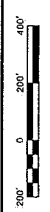

TOWNSHIP OF DEPTFORD
GLOUCESTER COUNTY

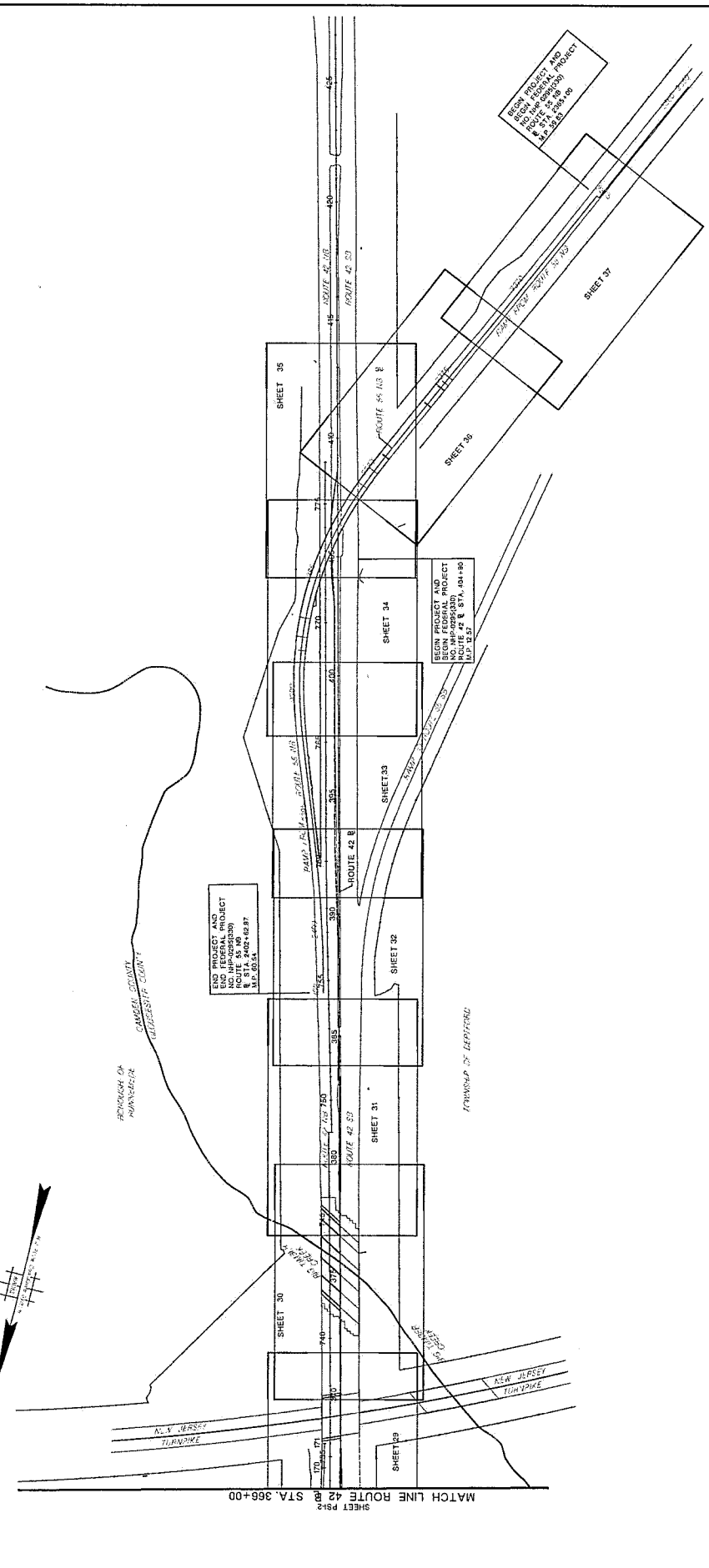
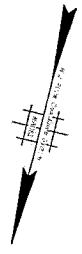

PSD
ESL

NEW JERSEY DEPARTMENT OF TRANSPORTATION

PLAN SHEET INDEX

1-295 / ROUTE 42 MISSING MOVES
CONTRACT NO. 029590041

DEWBERRY ENGINEERS, INC.
CERTIFICATION OF AUTHORIZATION NO. Z4042474700

JAMES D. HEEREN P.E.
NEW JERSEY PROFESSIONAL ENGINEER LICENSE NO. Z4042474700

4
40



469295 12-4250 9765801\CD\104\Plan\104\NewJersey\ESL\104\INDEX\104\29501.dwg

E-6

MAY 06 2019

STATE: NEW JERSEY PROJECT NO.: HPR-556-1(103)

GLoucester COUNTY

BOROUGH OF WESTVILLE

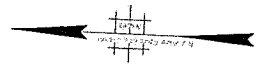

BEGIN PROJECT AND BEGIN FEDERAL PROJECT
STATION 1321+00
1-295 E NB STA. 1321+13
1-295 E SB STA. 1321+88
ALP 25-07

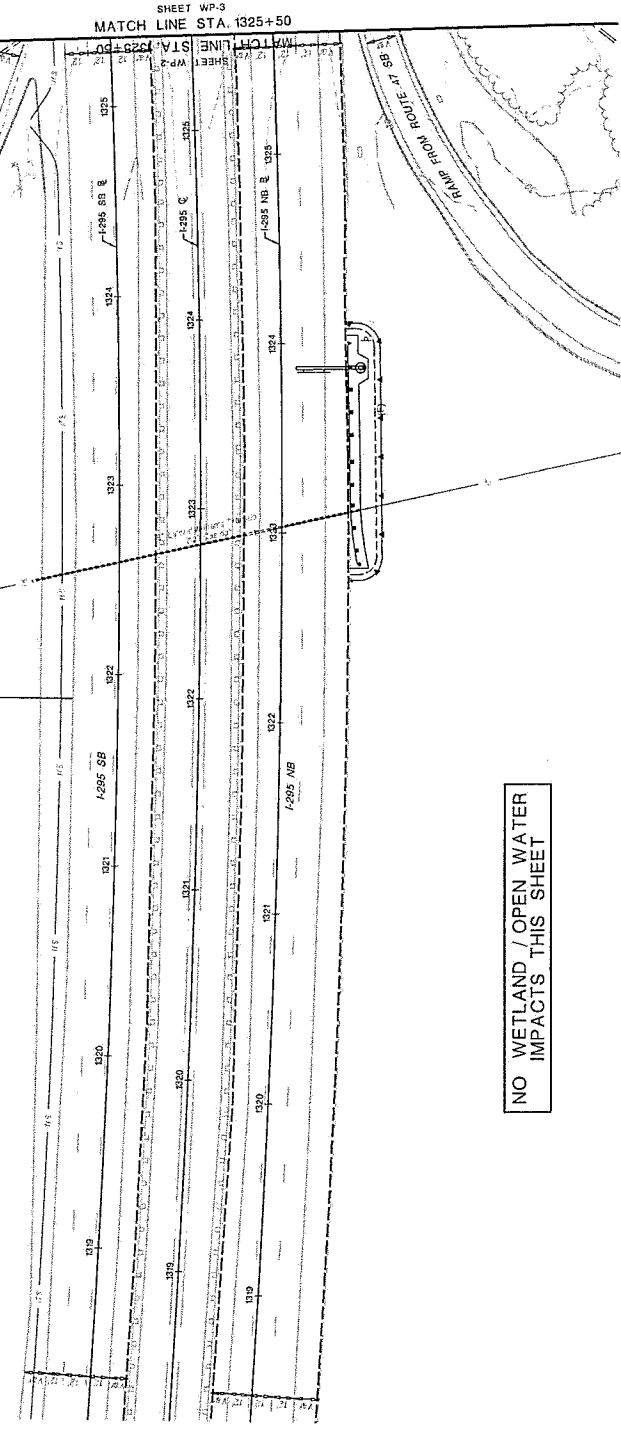

SHEET WP-3
MATCH LINE STA. 1325+50

NO WETLAND / OPEN WATER IMPACTS THIS SHEET

NEW JERSEY DEPARTMENT OF TRANSPORTATION

USACE WATERS OF THE U.S. PERMIT PLANS
1-295 / ROUTE 42 MISSING MOVES
CONTRACT NO. 029595541

CONTRACT NO. 029595541
CERTIFICATION OF AUTHORIZATION NO. 20040624700
JAMES D. HEEREN, P.E.
NEW JERSEY PROFESSIONAL ENGINEER LICENSE NO. 245040300

5
40



9795601/C:\d\1\proj\103\wp\wp-3.dwg 06/14/09 09:44:59

E-7

MAY 0 6 2019

GLoucester COUNTY

BOROUGH OF WESTVILLE
TOWNSHIP OF DEPTFORD

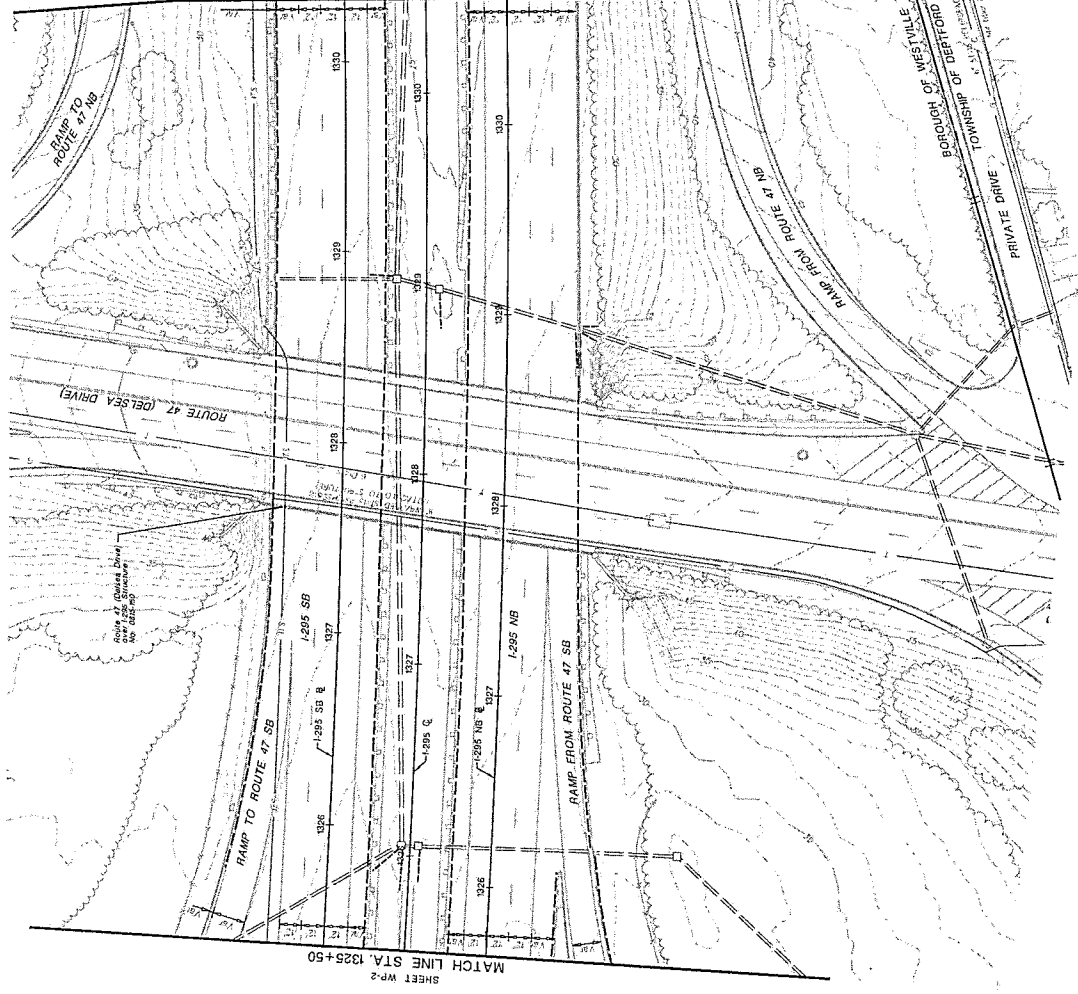

NO WETLAND / OPEN WATER
IMPACTS THIS SHEET

NO WORK THIS SHEET
(FOR INFORMATIONAL PURPOSES ONLY)

NEW JERSEY DEPARTMENT OF TRANSPORTATION

USACE WATERS OF
THE U.S. PERMIT PLANS
1-285 / ROUTE 42 MISSING MOVES
CONTRACT NO. 0285950541

DEWBERRY ENGINEERS INC.
REGISTERED PROFESSIONAL ENGINEER
JAMES D. WEBER P.E.
NEW JERSEY PROFESSIONAL ENGINEER LICENSE NO. 2466043000

6
40



9795502.CADD\Map\Drawings\USACE_M\134624\DWG\134624_01.DWG

MAY 06 2019

E-8

STATE FEDERAL PROJECT NO.
NJ: RPP02551 (02)

GLoucester COUNTY

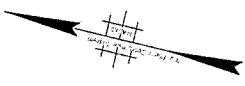

BOROUGH OF WESTVILLE
TOWNSHIP OF DEPTFORD

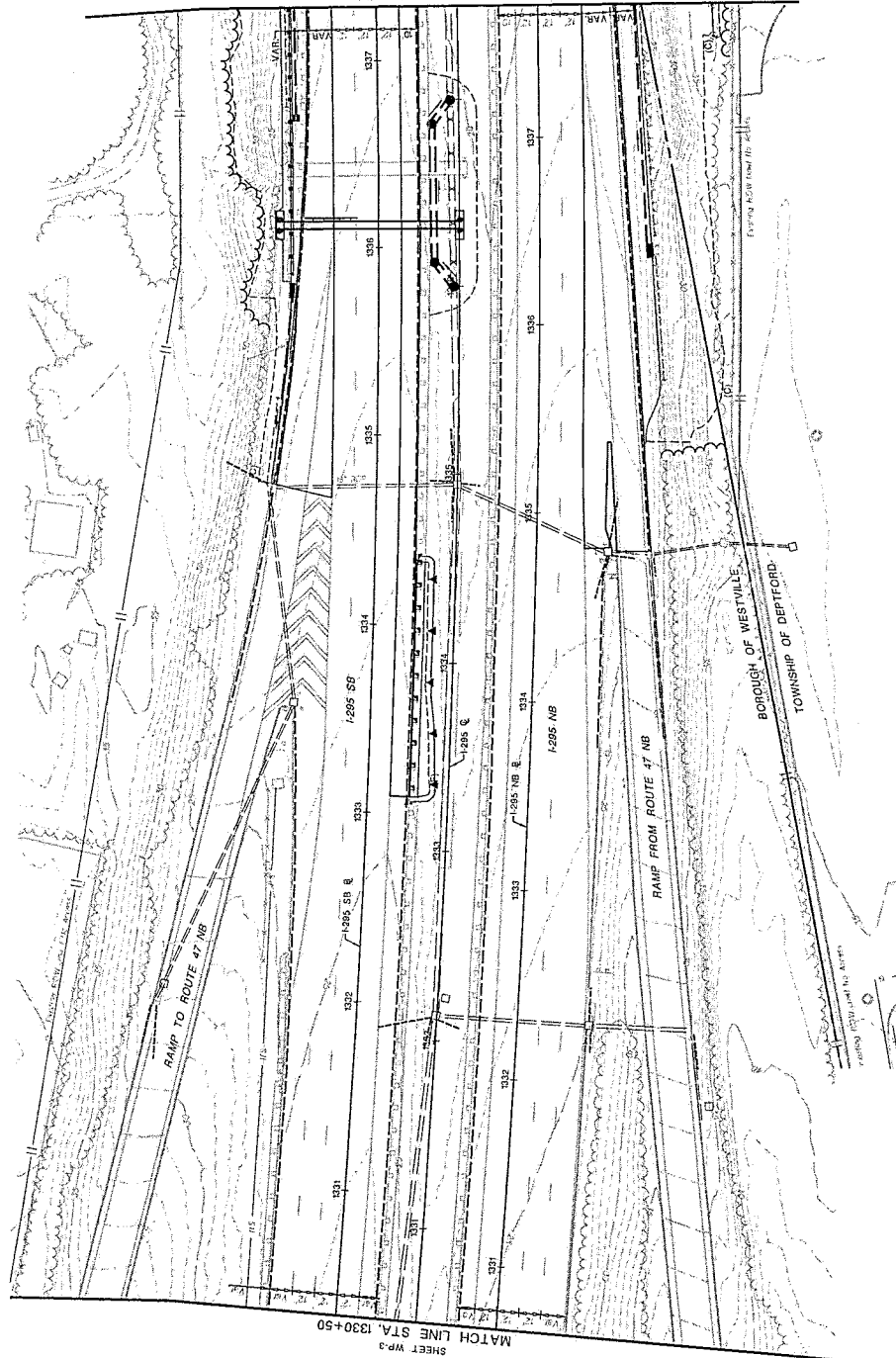

SHEET WP-5
MATCH LINE STA. 1337+50

SHEET WP-3
MATCH LINE STA. 1330+50

U.S. 301

NEW JERSEY DEPARTMENT OF TRANSPORTATION
USACE WATERS OF THE U.S. PERMIT PLANS
I-95 / ROUTE 42 MISSING MOVES
CONTRACT NO. 02959541
ENGINEERS INC.
CERTIFICATION OF AUTHORIZATION NO. 2404584760
JAMES B. HEFFREN, P.E.
NEW JERSEY PROFESSIONAL ENGINEER LICENSE NO. 240640000

NO WETLAND / OPEN WATER IMPACTS THIS SHEET

7
40

E-9

STATE PLANNING PROJECT NO.
N.J. PFP-2014 (03)

GLOUCESTER COUNTY

BOROUGH OF WESTVILLE
TOWNSHIP OF DEPTFORD

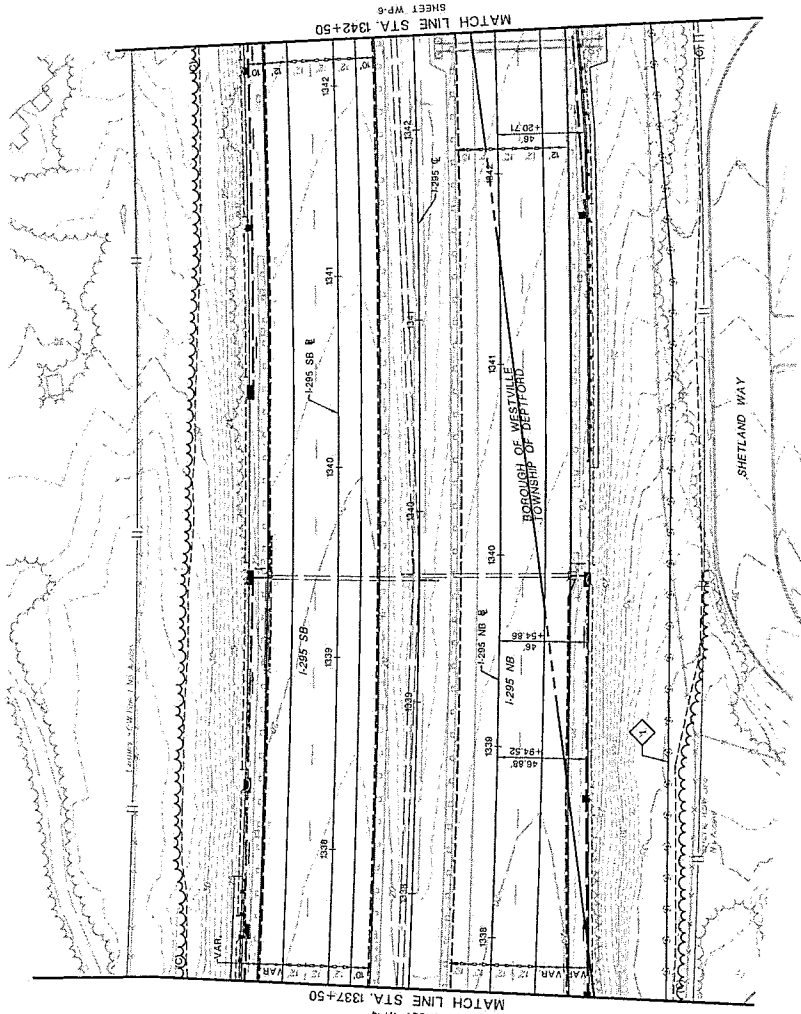

NO WETLAND / OPEN WATER
IMPACTS THIS SHEET

NEW JERSEY DEPARTMENT OF TRANSPORTATION

USACE WATERS OF THE U.S. PERMIT PLANS
1295 / ROUTE 42 MISSING MOVES
CONTRACT NO. 028398541

PERFORMING ENGINEERS INC.
CERTIFICATION OF AUTHORIZATION NO. 240242947000

JAMES D. HEEREN P.E.
NEW JERSEY PROFESSIONAL ENGINEER LICENSE NO. 240242947000

8
40



D:\WORK\14051\14051.dwg 4/28/19 8:43:53 97555551\001\001\Drawings\USACE\Plan\USACE\14051\14051.dwg

E-10

MAY 06 2019

STATE: NEW JERSEY
 FEDERAL PROJECT NO.:
 NJ: HPP-2645-1 (03)

GLoucester COUNTY



BOROUGH OF WESTVILLE
 TOWNSHIP OF DEPTFORD

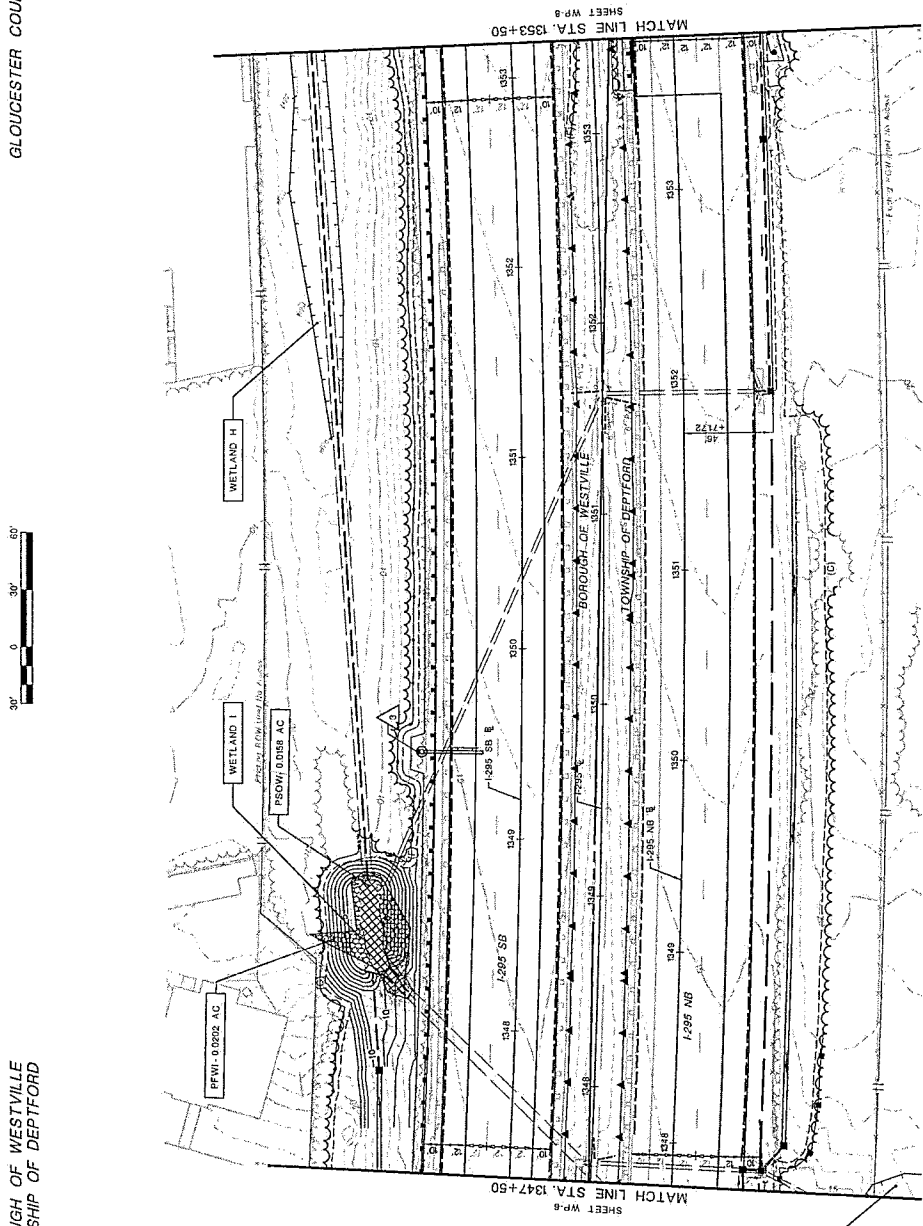

- LEGEND:**
- BORING LOCATION
 - MEAN HIGH WATER LINE (ELEVATION 3.2' NAVD 88S)
 - HIGH WATER LINE (ELEVATION 4.5' NAVD 88S)
 - DELINEATED WETLAND LINE
 - ▨ PERMANENT FRESHWATER WETLAND IMPACT (PFWI)
 - ▨ PERMANENT INTERTIDAL SHALLOWS IMPACT (PISI)
 - ▨ PERMANENT STATE OPEN WATER IMPACT (PSOWI)
 - ▨ TEMPORARY FRESHWATER WETLAND IMPACT (TFWI)
 - ▨ TEMPORARY INTERTIDAL SHALLOWS IMPACT (TISI)
 - ▨ TEMPORARY STATE OPEN WATER IMPACT (TSOWI)

WETLAND TYPE (AC)	TEMPORARY IMPACT (AC)	PERMANENT IMPACT (AC)	TOTAL IMPACT (AC)
WETLAND I (0.0358)	0.0358	0.0000	0.0358
WETLAND H (0.0202)	0.0202	0.0000	0.0202
TOTAL WETLANDS OF THE U.S.	0.0560	0.0000	0.0560

WP-7
 JES-2

NEW JERSEY DEPARTMENT OF TRANSPORTATION
USACE WATERS OF THE U.S. PERMIT PLANS
 I-295 / ROUTE 42 MISSING MOVES
 CONTRACT NO. 028905041
 ENGINEER: ENGINEERS, P.C.
 CERTIFICATION OF AUTHORIZATION NO. 2404282400
 JAMES D. MEEHAN, P.E.
 NEW JERSEY PROFESSIONAL ENGINEER LICENSE NO. 2404282400

10
 40



460799 08/18/18 3780001\CD\04\Plan\Permit\USACE_Plan\USACE\19752627_21.dwg

MAY 06 2019

2-12

STATE: NEW JERSEY
PROJECT NO.: HPP-295-1(03)

CAMDEN COUNTY
TEMPORARY EASEMENT LINE



BOROUGH OF BELLMAWR

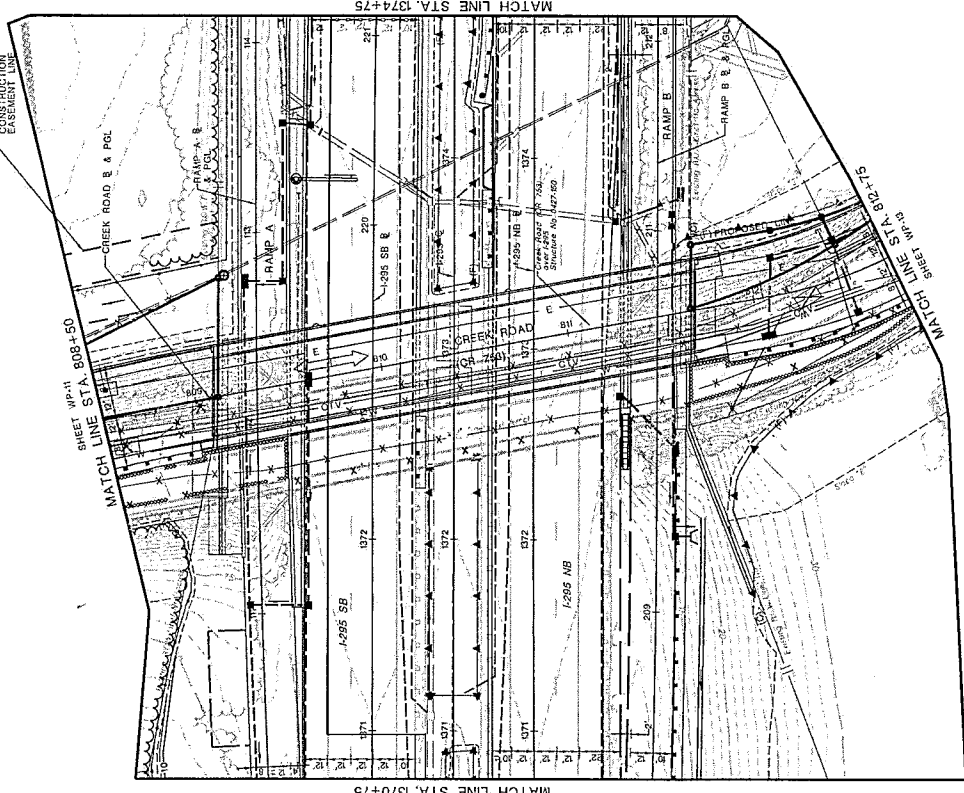
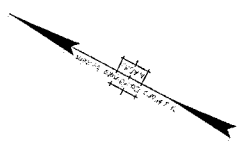

MATCH LINE STA. 1374+75
SHEET WP-14

MATCH LINE STA. 808+50
SHEET WP-11

MATCH LINE STA. 1370+75
SHEET WP-10

NO WETLAND / OPEN WATER
IMPACTS THIS SHEET

NEW JERSEY DEPARTMENT OF TRANSPORTATION
US-32

USACE WATERS OF
THE U.S. PERMIT PLANS
I-295 / ROUTE 42 MISSING MOVES
CONTRACT NO. 02690541

Dewberry Engineers, Inc.
Professional Engineer License No. 240643029
JAMES D. HERGEN, P.E.
NEW JERSEY PROFESSIONAL ENGINEER LICENSE NO. 240643029

LEGEND:
--- DELINEATED WETLAND LINE



1/10/19 09:46:13
I:\Projects\2018\02690541\Drawings\Permit\USACE\Plan\USACEWP2952_03.dwg

E-17

MAY 06 2019

BOROUGH OF BELLMAWR CAMDEN COUNTY

STATE FEDERAL PROJECT NO.
N.J. HPA-265-11001

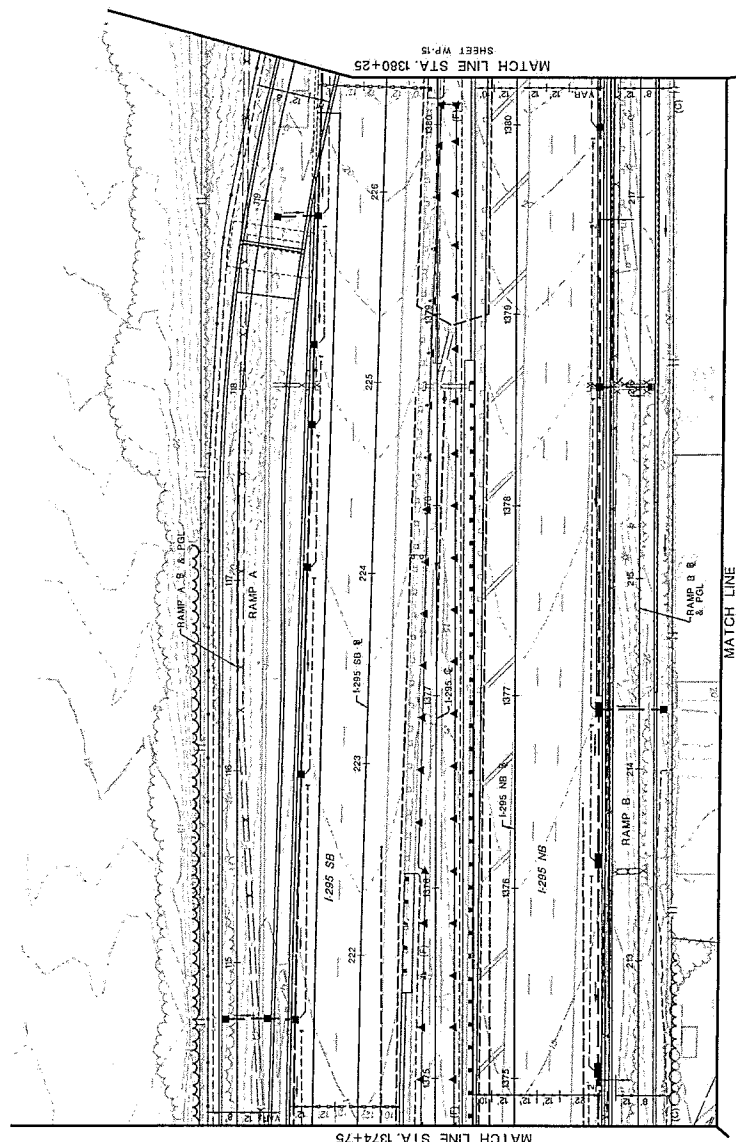
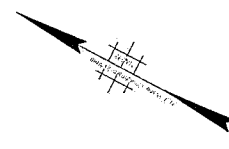

NO WETLAND / OPEN WATER
IMPACTS THIS SHEET

NEW JERSEY DEPARTMENT OF TRANSPORTATION
**USACE WATERS OF
 THE U.S. PERMIT PLANS**
 I-295 / ROUTE 42 MISSING MOVES
 CONTRACT NO. 02B60941

CONVEYED ENGINEERS, INC.
 CERTIFICATION OF AUTHORIZATION NO. 24073816700
 JAMES D. HEWEN, P.E.
 NEW JERSEY PROFESSIONAL ENGINEER LICENSE NO. 240684000

17
40

LEGEND:
 DELINEATED WETLAND LINE



E-19

MAY 06 2019

STATE PROJECT NO.
N.J.
HPD-25-1(10)

CAMDEN COUNTY

BOROUGH OF BELLMAWR

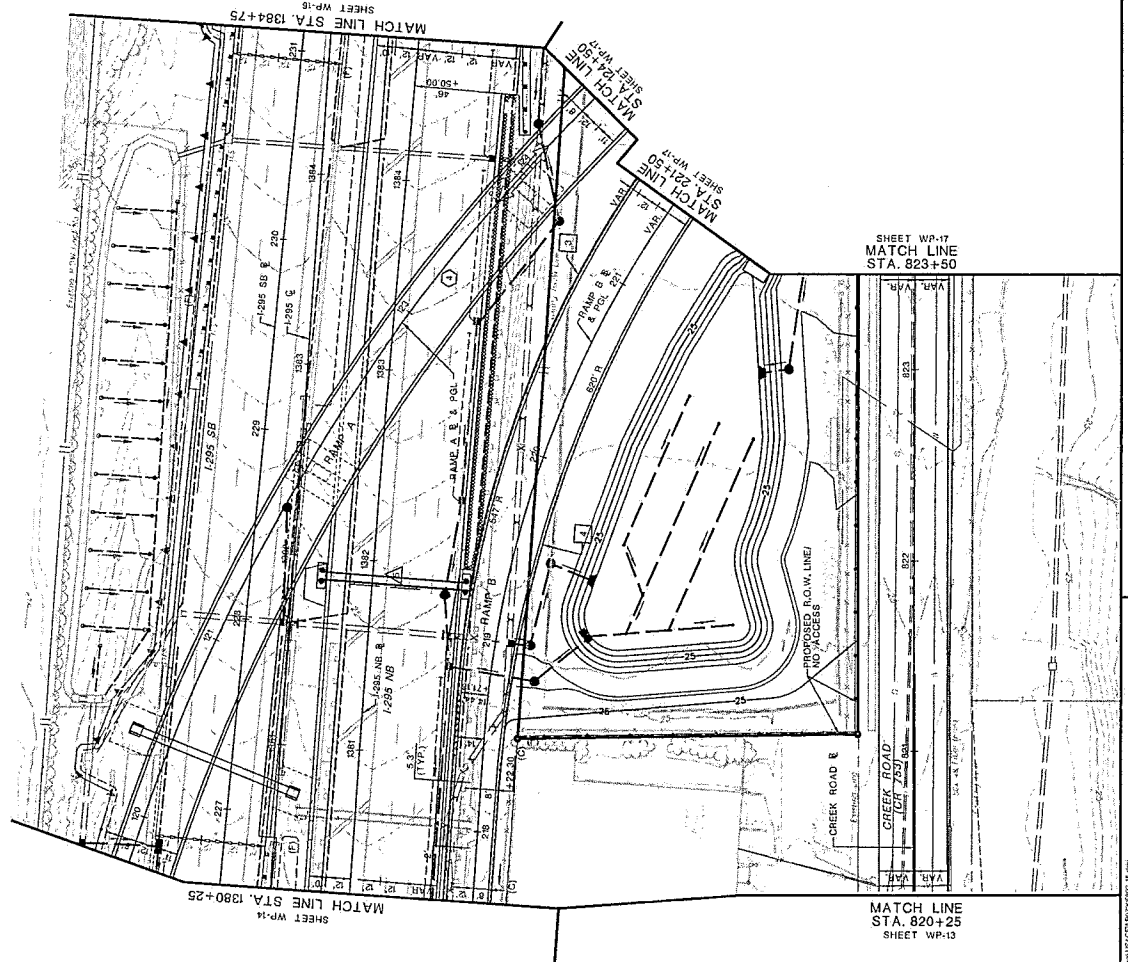
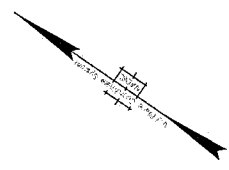

**NO WETLAND / OPEN WATER
IMPACTS THIS SHEET**

NEW JERSEY DEPARTMENT OF TRANSPORTATION
**USACE WATERS OF
THE U.S. PERMIT PLANS**
 I-295 / ROUTE 42 MISSING MOVES
 CONTRACT NO. 02850541

DEWBERRY ENGINEERS, INC.
 CERTIFICATION NO. 246484700
 JAMES D. DEEREN, P.E.
 NEW JERSEY PROFESSIONAL ENGINEER LICENSE NO. 246803008

18
40

SHEET WP-17
MATCH LINE
STA. 823+50

MATCH LINE
STA. 820+25
SHEET WP-13

MATCH LINE STA. 1380+25
SHEET WP-14

MATCH LINE STA. 1384+75
SHEET WP-16

E-20

MAY 06 2019

STATE: NEW JERSEY
SHEET: PERMIT PLAN 102
N.J. HPP-285-1 (03)

BOROUGH OF BELLMAR



END PROJECT AND
PROJECT SUBJECT
NO. NHP-0295(030)
1:295 NB STA. 1384+14
E.O.D. STA. 135+01
M.P. 28.35

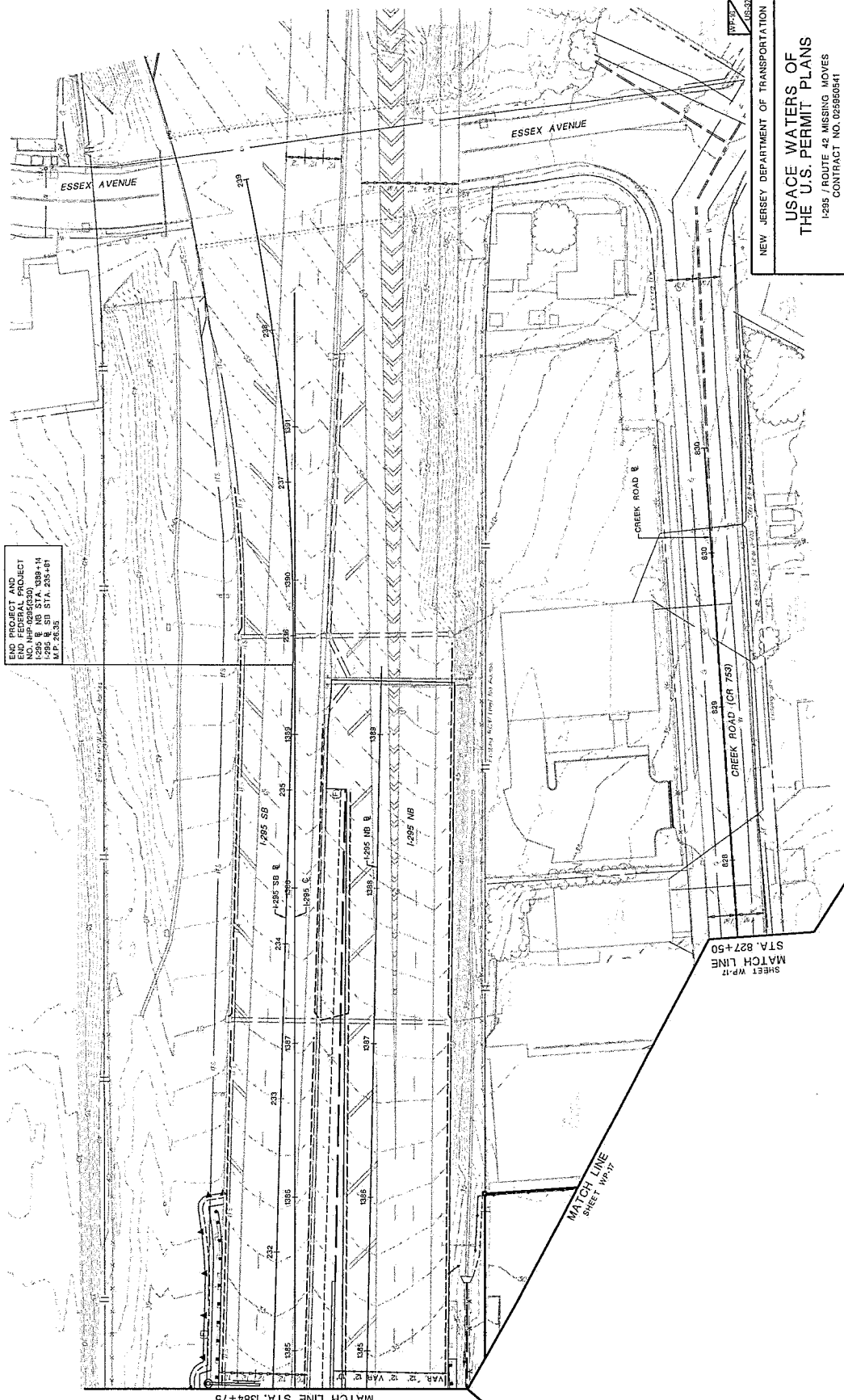

NEW JERSEY DEPARTMENT OF TRANSPORTATION
USACE WATERS OF THE U.S. PERMIT PLANS
1:295 / ROUTE 42 MISSING MOVES
CONTRACT NO. 02950041
DESIGNED BY: ENGINEERS, INC.
CERTIFICATION OF AUTHORIZATION: NO. 24043807500
JAMES D. GREENE, P.E.
NEW JERSEY PROFESSIONAL ENGINEER LICENSE NO. 246602000

NO WETLAND / OPEN WATER
IMPACTS THIS SHEET

19
40

87926002(CAD)\\CAD\\Plan\\Permit\\USACE_NHP\\CAD\\NHP285001_31.dwg 09/16/03 442078

12-3

MAY 06 2019

CAMDEN COUNTY

BOROUGH OF BELLMAWR

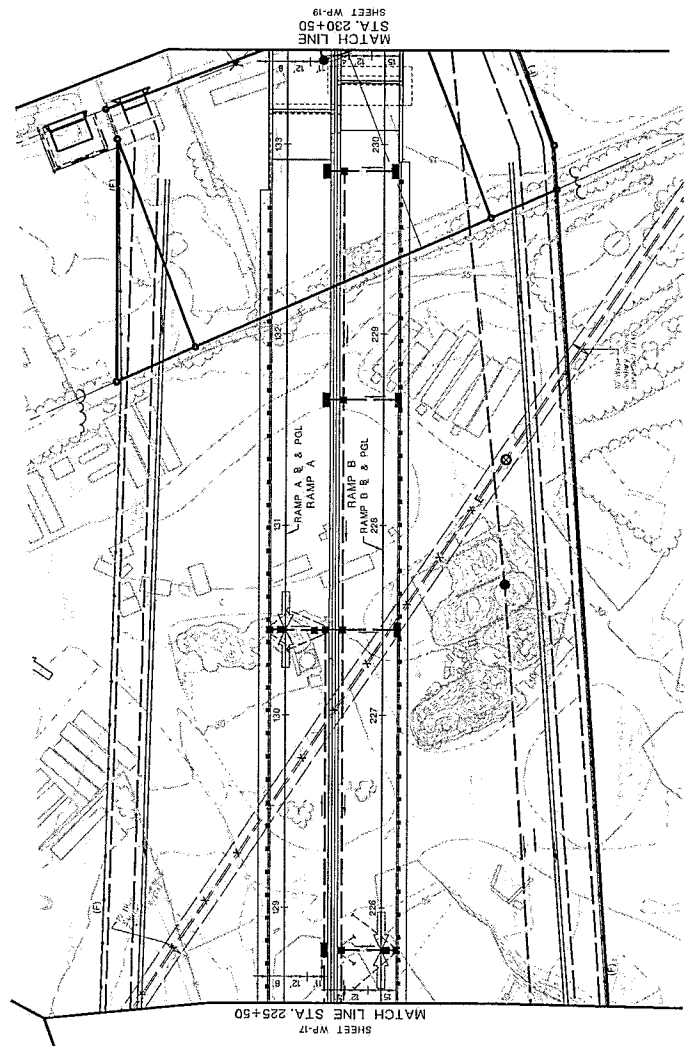

NO WETLAND / OPEN WATER IMPACTS THIS SHEET

NEW JERSEY DEPARTMENT OF TRANSPORTATION
USACE WATERS OF THE U.S. PERMIT PLANS
1285 / ROUTE 42 MISSING MOVES
CONTRACT NO. 028950541
ENGINEER: JAMES D. MEEREN, P.E.

21 / 40



E-23

MAY 06 2019

STATE OF NEW JERSEY
N.J. H.P. 2024-100

CAMDEN COUNTY

BOROUGH OF BELLMAWR

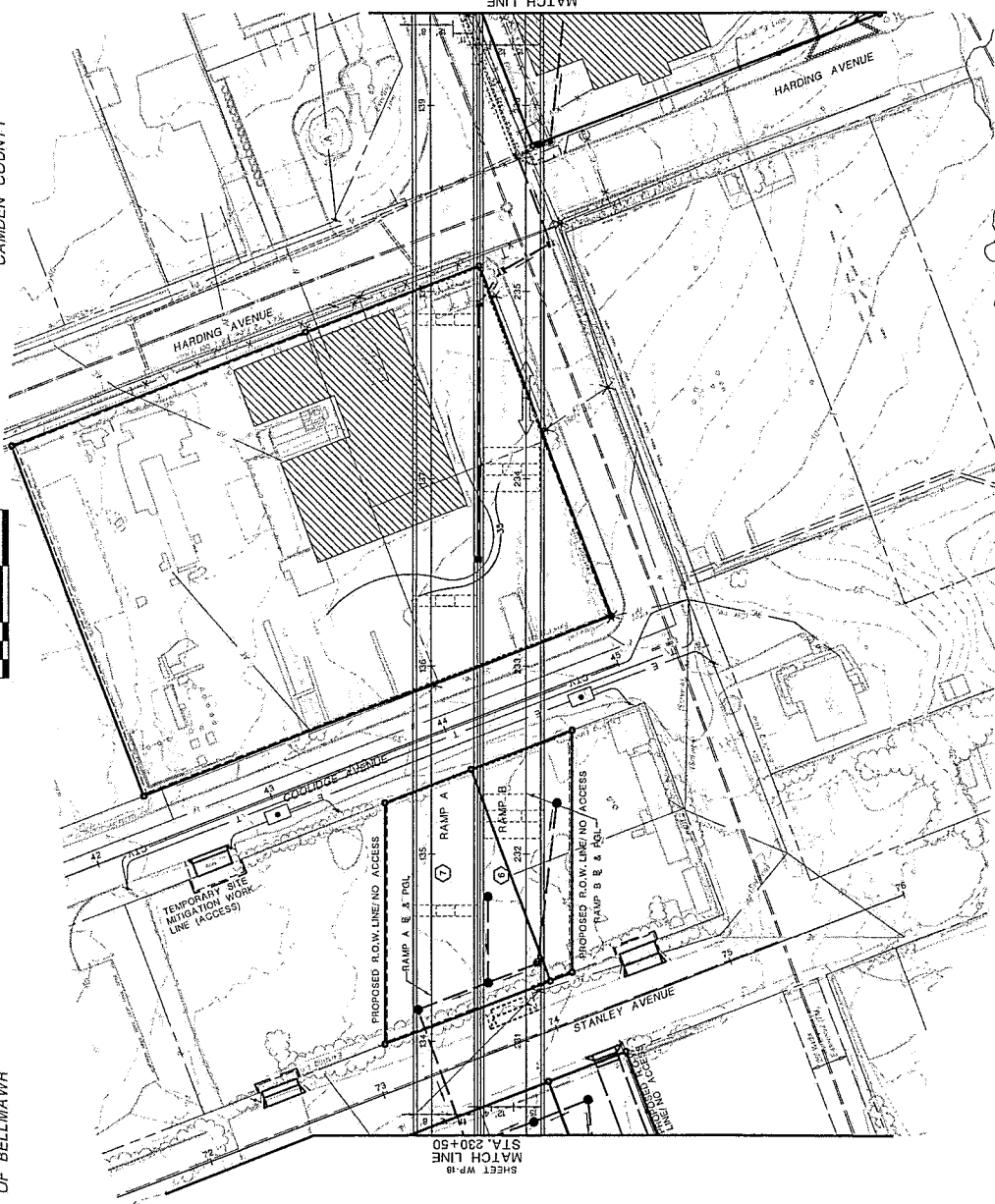

SHEET WP-18
MATCH LINE
STA. 230+50

SHEET WP-23
MATCH LINE
STA. 236+50

NO WETLAND / OPEN WATER
IMPACTS THIS SHEET

APP-33
CLASS

NEW JERSEY DEPARTMENT OF TRANSPORTATION

USACE WATERS OF
THE U.S. PERMIT PLANS
1-2816 / ROUTE 49 MISSING MOVES
CONTRACT NO. 028960841

DEWBERRY ENGINEERS, INC.
CERTIFICATION OF AUTHORIZATION NO. 240328247500
JAMES D. HEEREN, P.E.
NEW JERSEY PROFESSIONAL ENGINEER LICENSE NO. 2406801000

22
40

496079 09/14/19 87700001-C:\AD\DWG\Plan\Permit\USACE_Plan\USACEWP18.dwg



MAY 06 2019

E-24

CAMDEN COUNTY

BOROUGH OF BELLMAWR

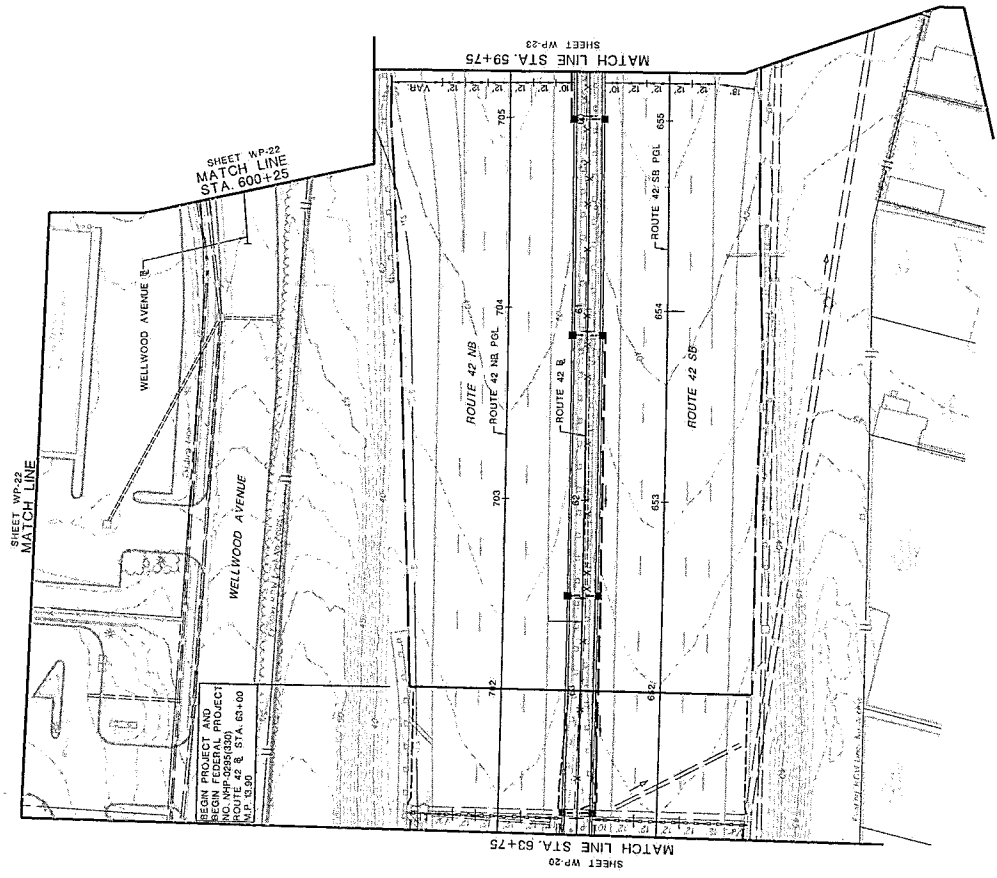
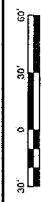

STATE FIDELITY PROJECT NO.
N.J. HPS-2854 (03)

NO WETLAND / OPEN WATER
IMPACTS THIS SHEET

NEW JERSEY DEPARTMENT OF TRANSPORTATION
USACE WATERS OF
THE U.S. PERMIT PLANS
1295 / ROUTE 42 MGSING MOVES
CONTRACT NO. 05960541
NEW JERSEY ENGINEERS, INC.
CERTIFICATION OF AUTHORIZATION NO. 210A2827600
JAMES D. KEREN, P.E.
NEW JERSEY PROFESSIONAL ENGINEER LICENSE NO. Z46040000

24
4.0



925500/CADD/Drawings/Permit/12902 Perms/USACE/12902_74.dwg

5-26

MAY 06 2019

CAMDEN COUNTY

BOROUGH OF BELLMAWR



STATE FEDERAL PROJECT NO.
N.J. HPP-2851 (R3)

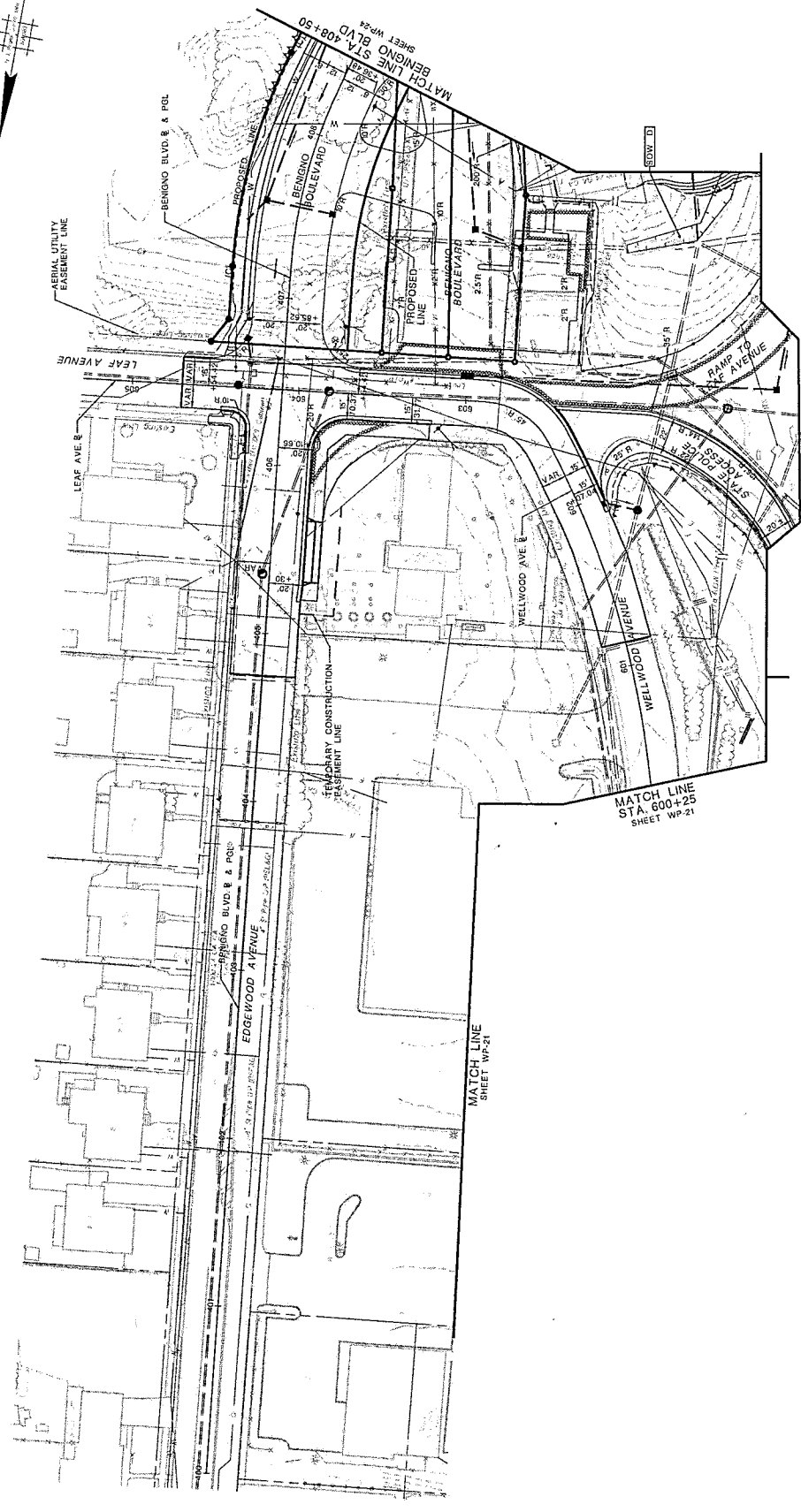

HPP-2851
NEW JERSEY DEPARTMENT OF TRANSPORTATION

USACE WATERS OF
THE U.S. PERMIT PLANS
I-295 /ROUTE 42 MISSING MOVES
CONTRACT NO. U29590941

CONTRACT NO. U29590941
CERTIFICATION OF AUTHORIZATION NO. 242632817308
JAMES O. MEEREN, P.E.
NEW JERSEY PROFESSIONAL ENGINEER LICENSE NO. 2162840300

NO WETLAND / OPEN WATER
IMPACTS THIS SHEET

MATCH LINE
SHEET WP-23

MATCH LINE
STA. 600+25
SHEET WP-21

MATCH LINE
SHEET WP-21

MATCH LINE
STA. 408+50
SHEET WP-24



4/16/2019 10:56:13 AM \\P:\2851\CD\Draw\Plan\USACE_HPP\USACE_HPP_WP23.dwg

E-27

MAY 06 2019

STATE FEDERAL PROJECT NO.
N.J. RFP-2015-1 (B3)

BOROUGH OF BELLMAWR

CAMDEN COUNTY

4/20/19 09:42:58
D:\MSR\19\14000
9795662 CAD\DWG\Plan\Permit\USACE_Ren\150421\WP2506C_01.dwg

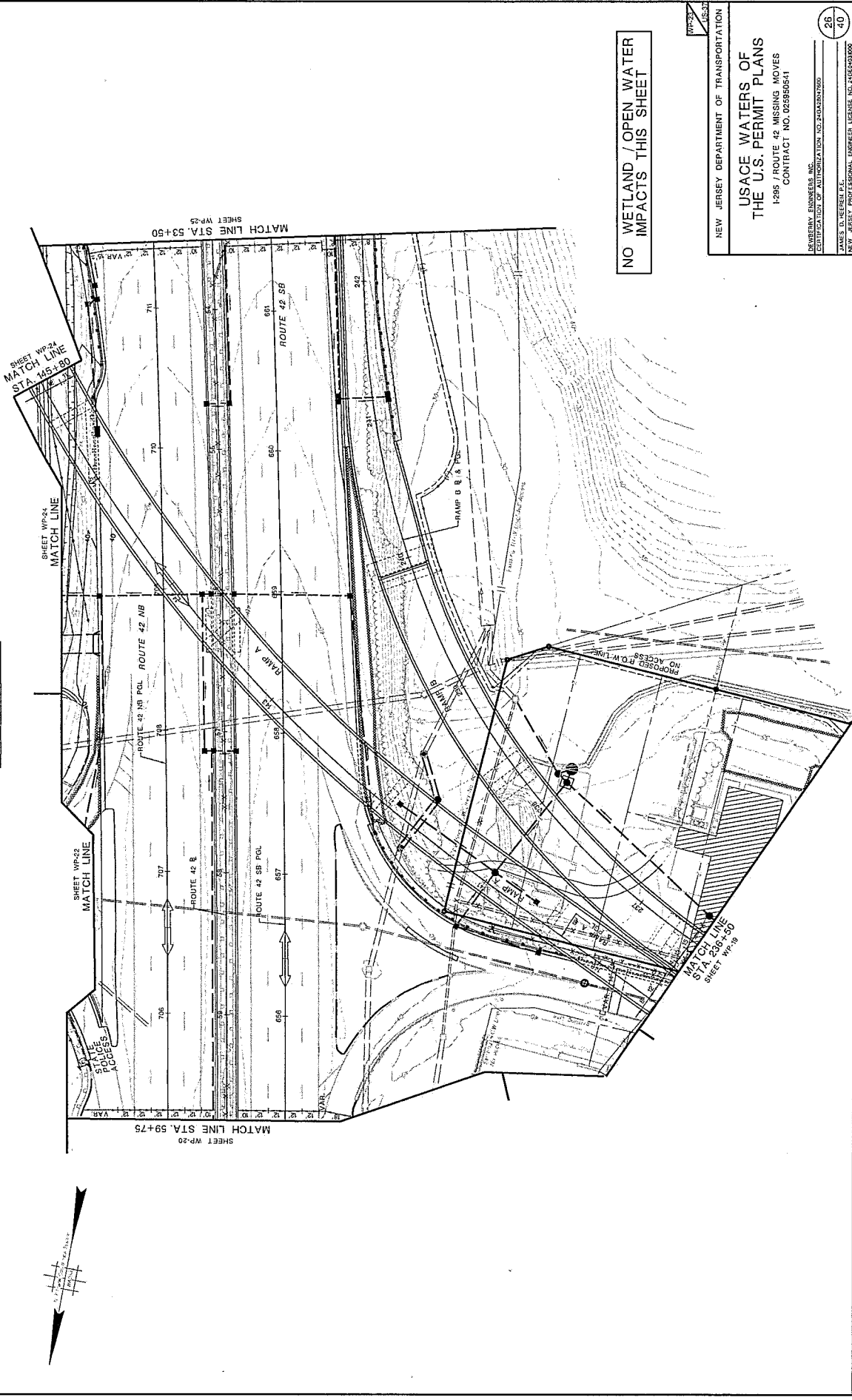

NO WETLAND / OPEN WATER
IMPACTS THIS SHEET

NEW JERSEY DEPARTMENT OF TRANSPORTATION

**USACE WATERS OF
THE U.S. PERMIT PLANS**

1285 / ROUTE 42 MISSING MOVES
CONTRACT NO. 025950541

DEWBERRY ENGINEERS, INC.
REGISTERED PROFESSIONAL ENGINEER
STATE OF NEW JERSEY LICENSE NO. 2404202700

JAMES D. NEERBET, P.E.

28
40



E-28

MAY 06 2019

BOROUGH OF BELLMAWR

CAMDEN COUNTY

STATE: DELAWARE PROJECT NO.: N.A. I.P.P. 08-11 (20)

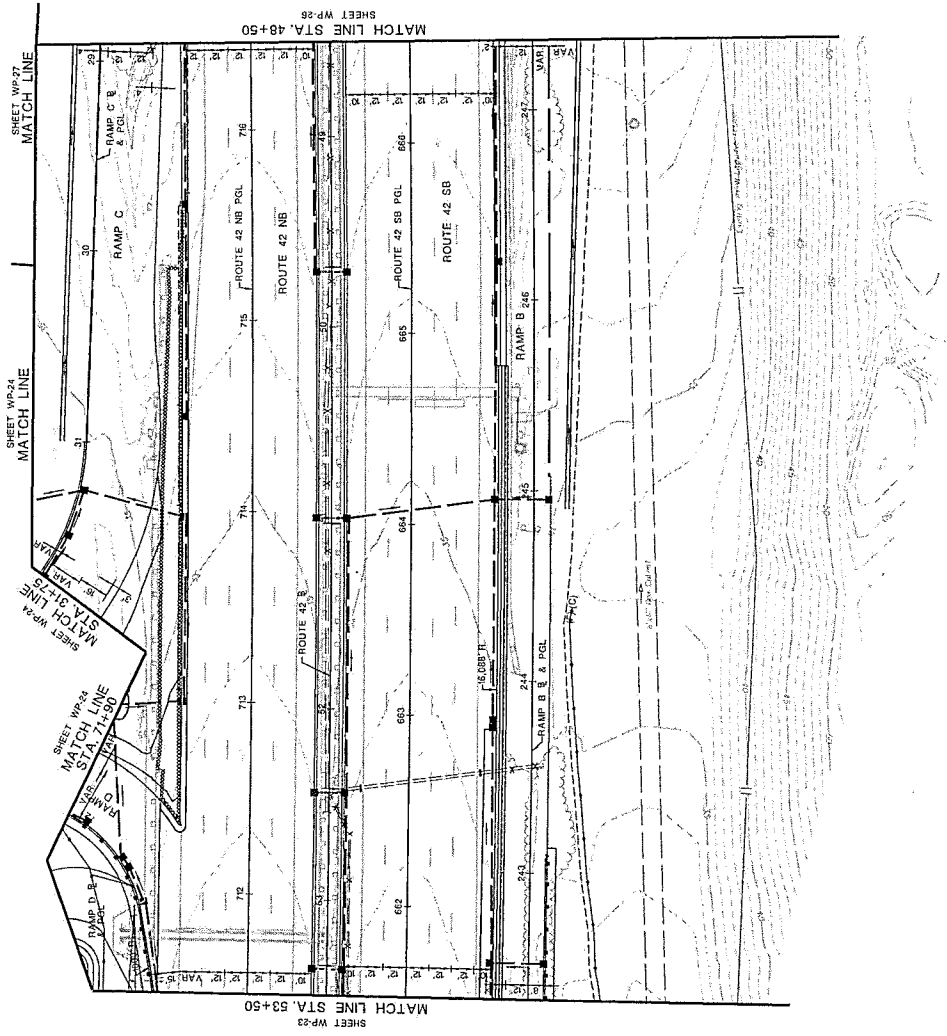

NO WETLAND / OPEN WATER IMPACTS THIS SHEET

NEW JERSEY DEPARTMENT OF TRANSPORTATION

USACE WATERS OF THE U.S. PERMIT PLANS

1-296 / ROUTE 42 MISSING MOVES

CONTRACT NO. 025695941

STATE OF NEW JERSEY PROFESSIONAL ENGINEER LICENSE NO. 246240000

JAMES D. HERREN, P.E.

CERTIFICATION OF AUTHORIZATION NO. 246240000

28

4.0



9:55:00 AM C:\Users\jherren\Documents\USACE Permits\025695952_7101.dwg 08/11/2019 4:02:29 PM

E-30

MAY 06 2019

STATE: N.J. FEDERAL PROJECT NO. HP-086-1 (P2)

CAMDEN COUNTY

BOROUGH OF BELLMAWR

DATE: 05/16/19

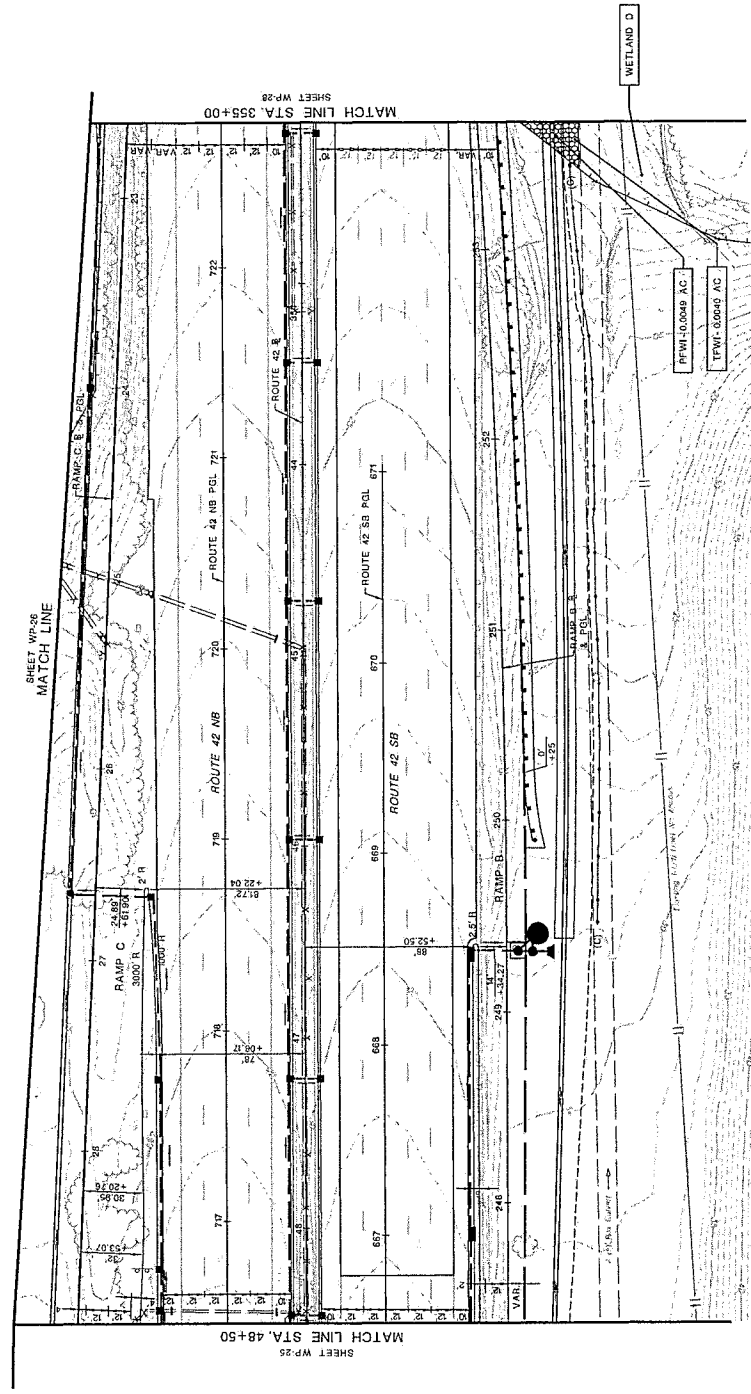

LEGEND:

- BORING LOCATION
- MEAN HIGH WATER LINE (MSL)
- HIGH TIDE LINE / SPRING HIGH TIDE LINE (ELEVATION 4.33 NAVD 1988)
- DELINEATED WETLAND LINE
- ▨ PERMANENT FRESHWATER WETLAND IMPACT (PFWI)
- ▩ PERMANENT INTERTIDAL SHALLOWS IMPACT (PIBI)
- ▧ PERMANENT STATE OPEN WATER IMPACT (PSOW)
- ▦ TEMPORARY FRESHWATER WETLAND IMPACT (TFWI)
- ▤ TEMPORARY INTERTIDAL SHALLOWS IMPACT (TIBI)
- ▥ TEMPORARY STATE OPEN WATER IMPACT (TSOW)

WETLANDS (FBI AC)	PERMANENT FRESHWATER WETLANDS (PFW)	PERMANENT INTERTIDAL SHALLOWS (PIS)	PERMANENT STATE OPEN WATER (PSOW)	TOTAL IMPACT
0.0000	0.0000	0.0000	0.0000	0.0000
0.0000	0.0000	0.0000	0.0000	0.0000
0.0000	0.0000	0.0000	0.0000	0.0000
0.0000	0.0000	0.0000	0.0000	0.0000

NEW JERSEY DEPARTMENT OF TRANSPORTATION
USACE WATERS OF THE U.S. PERMIT PLANS
 1-295 / ROUTE 42 MISSING MOVES
 CONTRACT NO. 029505941

NEW JERSEY ENGINEERS, INC.
 CERTIFICATION OF AUTHORIZATION NO. 24043047260

JAMES D. HEEREN, P.E.
 NEW JERSEY PROFESSIONAL ENGINEER LICENSE NO. 2404304000

29
4/0



MAY 06 2019

E-31

CAMDEN COUNTY

BOROUGH OF BELLMAWR



DATE: 12/15/10
SCALE: 1"=30'
SHEET: WP-23

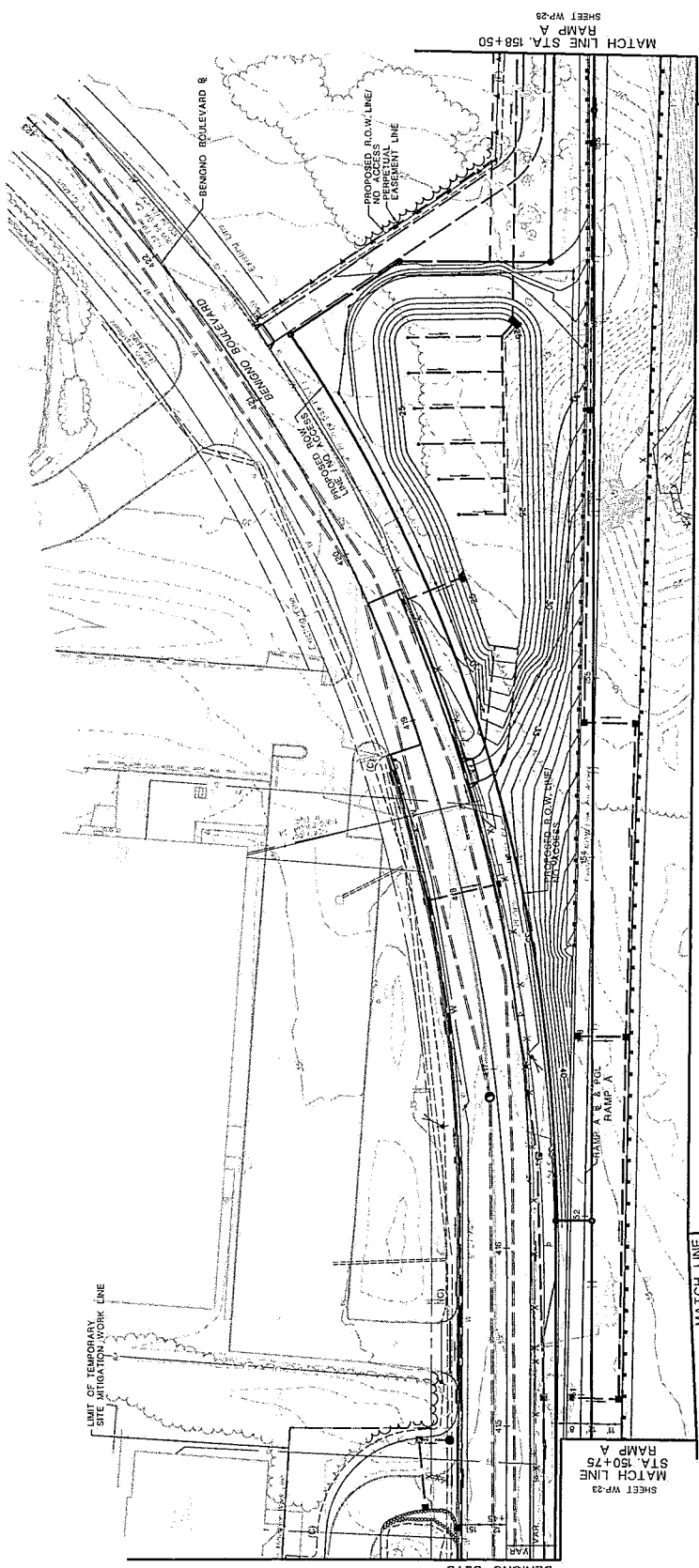

MATCH LINE
SHEET WP-26

MATCH LINE
SHEET WP-25

MATCH LINE STA. 158+50
RAMP A
SHEET WP-23

NO WETLAND / OPEN WATER
IMPACTS THIS SHEET

LEGEND:
DELINEATED WETLAND LINE

NEW JERSEY DEPARTMENT OF TRANSPORTATION
**USACE WATERS OF
THE U.S. PERMIT PLANS**
I-295 / ROUTE 42 MISSING MOVES
CONTRACT NO. 059850541

DEWBERRY ENGINEERS INC.
CERTIFICATION OF AUTHORIZATION NO. 2400292760
CLARENCE D. HEDGECOCK, P.E.
NEW JERSEY PROFESSIONAL ENGINEER LICENSE NO. 2436240300
30
410



9725001/CAD/CAD/Plan/Perms/USACE Perms/USACE/Perms/9725001_37.dwg 08/26/27 4/20/09

E-32

MAY 06 2019

STATE OF NEW JERSEY
 N.J. HPP-254 (10)

CAMDEN COUNTY

BOROUGH OF BELLMAR
 BOROUGH OF RUNNEMEDE

4/20/13 04/20/13

Dewberry

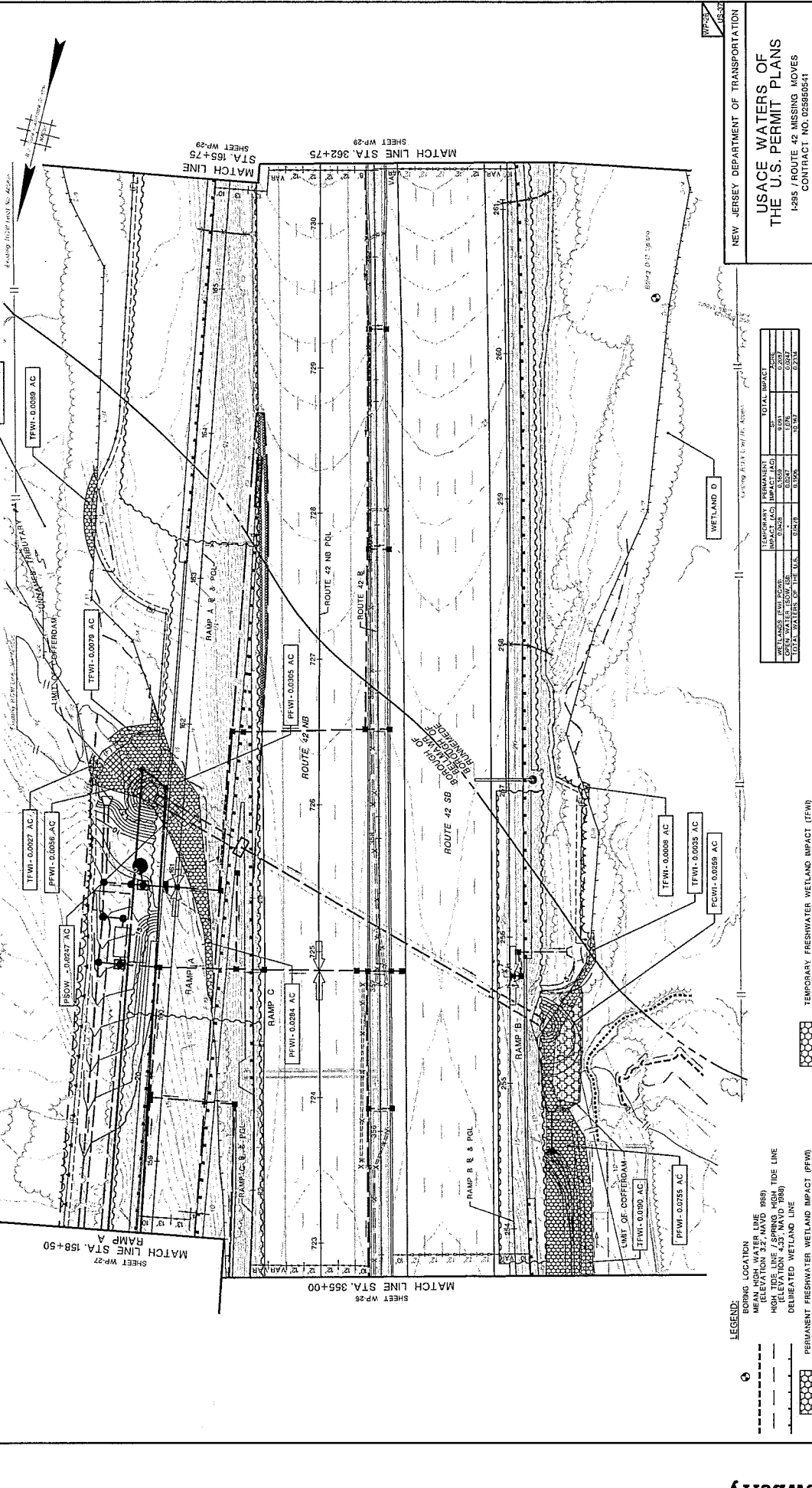

30' 0 30' 60'

SCALE

DATE

BY

CHECKED

APPROVED

DATE

BY

CHECKED

APPROVED

DATE

BY

CHECKED

APPROVED

DATE

BY

CHECKED

APPROVED

DATE

BY

CHECKED

APPROVED

DATE

BY

CHECKED

APPROVED

DATE

BY

CHECKED

APPROVED

MATCH LINE STA. 158+50

SHEET WP-27

RAMP A

PSOW-0.0027 AC

TFWI-0.0027 AC

PFWI-0.0084 AC

PFWI-0.0079 AC

TFWI-0.0088 AC

PFWI-0.0035 AC

ROUTE 42 NB

ROUTE 42 SB

ROUTE 49 NB PCL

ROUTE 42 B

RAMP B

RAMP C

PFWI-0.0084 AC

PFWI-0.0025 AC

PFWI-0.0025 AC

FCWI-0.0025 AC

WETLAND D

WETLAND E

TFWI-0.0088 AC

PFWI-0.0035 AC

ROUTE 42 NB

ROUTE 42 SB

ROUTE 49 NB PCL

ROUTE 42 B

RAMP A, B & PCL

LIMIT OF COFFERDAM

EMB OF COFFERDAM

MATCH LINE STA. 365+00

SHEET WP-28

RAMP A

PSOW-0.0027 AC

TFWI-0.0027 AC

PFWI-0.0084 AC

PFWI-0.0079 AC

TFWI-0.0088 AC

PFWI-0.0035 AC

ROUTE 42 NB

ROUTE 42 SB

ROUTE 49 NB PCL

ROUTE 42 B

RAMP B

RAMP C

PFWI-0.0084 AC

PFWI-0.0025 AC

PFWI-0.0025 AC

FCWI-0.0025 AC

WETLAND D

WETLAND E

TFWI-0.0088 AC

PFWI-0.0035 AC

ROUTE 42 NB

ROUTE 42 SB

ROUTE 49 NB PCL

ROUTE 42 B

RAMP A, B & PCL

LIMIT OF COFFERDAM

EMB OF COFFERDAM

MATCH LINE STA. 158+50

SHEET WP-27

RAMP A

PSOW-0.0027 AC

TFWI-0.0027 AC

PFWI-0.0084 AC

PFWI-0.0079 AC

TFWI-0.0088 AC

PFWI-0.0035 AC

ROUTE 42 NB

ROUTE 42 SB

ROUTE 49 NB PCL

ROUTE 42 B

RAMP B

RAMP C

PFWI-0.0084 AC

PFWI-0.0025 AC

PFWI-0.0025 AC

FCWI-0.0025 AC

WETLAND D

WETLAND E

TFWI-0.0088 AC

PFWI-0.0035 AC

ROUTE 42 NB

ROUTE 42 SB

ROUTE 49 NB PCL

ROUTE 42 B

RAMP A, B & PCL

LIMIT OF COFFERDAM

EMB OF COFFERDAM

MATCH LINE STA. 365+00

SHEET WP-28

RAMP A

PSOW-0.0027 AC

TFWI-0.0027 AC

PFWI-0.0084 AC

PFWI-0.0079 AC

TFWI-0.0088 AC

PFWI-0.0035 AC

ROUTE 42 NB

ROUTE 42 SB

ROUTE 49 NB PCL

ROUTE 42 B

RAMP B

RAMP C

PFWI-0.0084 AC

PFWI-0.0025 AC

PFWI-0.0025 AC

FCWI-0.0025 AC

WETLAND D

WETLAND E

TFWI-0.0088 AC

PFWI-0.0035 AC

ROUTE 42 NB

ROUTE 42 SB

ROUTE 49 NB PCL

ROUTE 42 B

RAMP A, B & PCL

LIMIT OF COFFERDAM

EMB OF COFFERDAM

MATCH LINE STA. 158+50

SHEET WP-27

RAMP A

PSOW-0.0027 AC

TFWI-0.0027 AC

PFWI-0.0084 AC

PFWI-0.0079 AC

TFWI-0.0088 AC

PFWI-0.0035 AC

ROUTE 42 NB

ROUTE 42 SB

ROUTE 49 NB PCL

ROUTE 42 B

RAMP B

RAMP C

PFWI-0.0084 AC

PFWI-0.0025 AC

PFWI-0.0025 AC

FCWI-0.0025 AC

WETLAND D

WETLAND E

TFWI-0.0088 AC

PFWI-0.0035 AC

ROUTE 42 NB

ROUTE 42 SB

ROUTE 49 NB PCL

ROUTE 42 B

RAMP A, B & PCL

LIMIT OF COFFERDAM

EMB OF COFFERDAM

MATCH LINE STA. 365+00

SHEET WP-28

RAMP A

PSOW-0.0027 AC

TFWI-0.0027 AC

PFWI-0.0084 AC

PFWI-0.0079 AC

TFWI-0.0088 AC

PFWI-0.0035 AC

ROUTE 42 NB

ROUTE 42 SB

ROUTE 49 NB PCL

ROUTE 42 B

RAMP B

RAMP C

PFWI-0.0084 AC

PFWI-0.0025 AC

PFWI-0.0025 AC

FCWI-0.0025 AC

WETLAND D

WETLAND E

TFWI-0.0088 AC

PFWI-0.0035 AC

ROUTE 42 NB

ROUTE 42 SB

ROUTE 49 NB PCL

ROUTE 42 B

RAMP A, B & PCL

LIMIT OF COFFERDAM

EMB OF COFFERDAM

MATCH LINE STA. 158+50

SHEET WP-27

RAMP A

PSOW-0.0027 AC

TFWI-0.0027 AC

PFWI-0.0084 AC

PFWI-0.0079 AC

TFWI-0.0088 AC

PFWI-0.0035 AC

ROUTE 42 NB

ROUTE 42 SB

ROUTE 49 NB PCL

ROUTE 42 B

RAMP B

RAMP C

PFWI-0.0084 AC

PFWI-0.0025 AC

PFWI-0.0025 AC

FCWI-0.0025 AC

WETLAND D

WETLAND E

TFWI-0.0088 AC

PFWI-0.0035 AC

ROUTE 42 NB

ROUTE 42 SB

ROUTE 49 NB PCL

ROUTE 42 B

RAMP A, B & PCL

LIMIT OF COFFERDAM

EMB OF COFFERDAM

MATCH LINE STA. 365+00

SHEET WP-28

RAMP A

PSOW-0.0027 AC

TFWI-0.0027 AC

PFWI-0.0084 AC

PFWI-0.0079 AC

TFWI-0.0088 AC

PFWI-0.0035 AC

ROUTE 42 NB

ROUTE 42 SB

ROUTE 49 NB PCL

ROUTE 42 B

RAMP B

RAMP C

PFWI-0.0084 AC

PFWI-0.0025 AC

PFWI-0.0025 AC

FCWI-0.0025 AC

WETLAND D

WETLAND E

TFWI-0.0088 AC

PFWI-0.0035 AC

ROUTE 42 NB

ROUTE 42 SB

ROUTE 49 NB PCL

ROUTE 42 B

RAMP A, B & PCL

LIMIT OF COFFERDAM

EMB OF COFFERDAM

MATCH LINE STA.

TOWNSHIP OF DEPTFORD
GLOUCESTER COUNTY

BOROUGH OF RUNNEMEDE
CAMDEN COUNTY

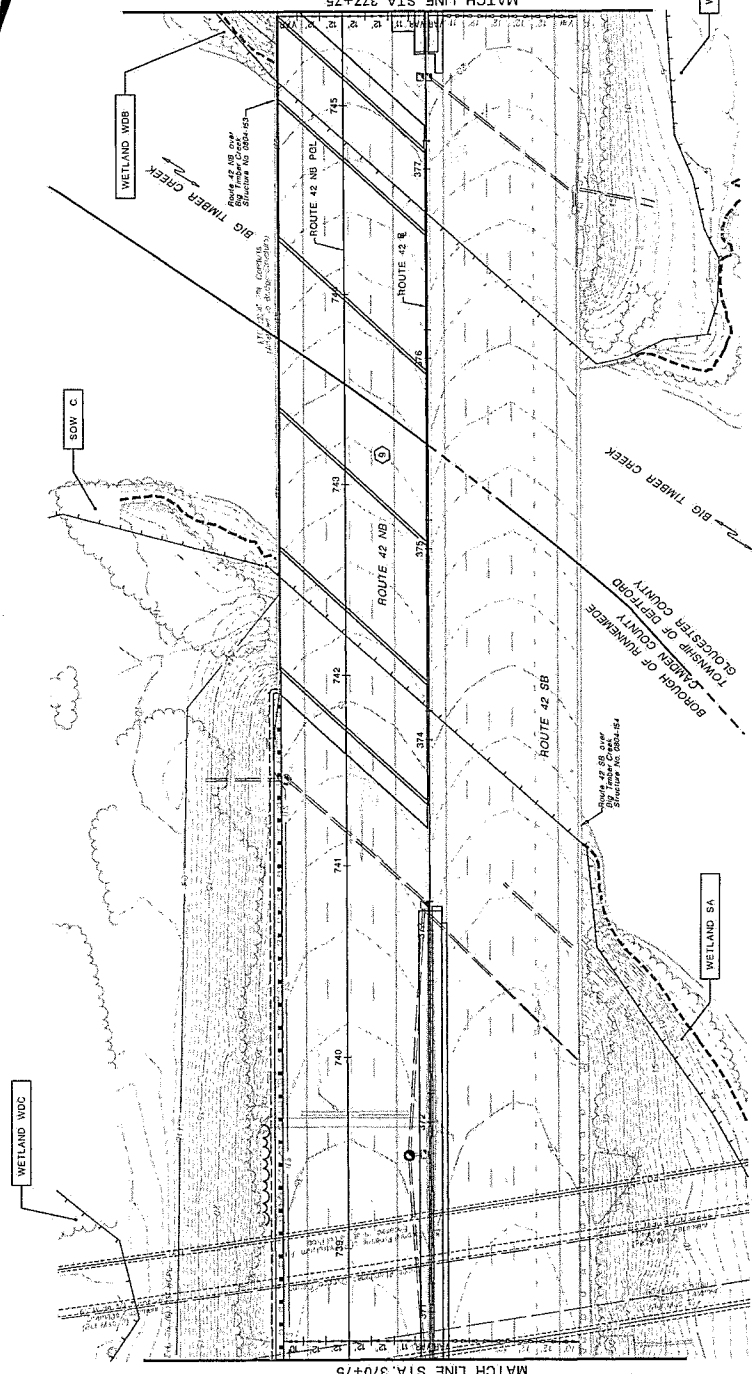

- LEGEND:**
- ⊙ BORING LOCATION
 - MEAN HIGH WATER LINE (ELEVATION 3.2' NAVD 1988)
 - HIGH TIDE LINE (ELEVATION 4.5' NAVD 1988)
 - DELINEATED WETLAND LINE
 - ▨ PERMANENT FRESHWATER WETLAND IMPACT (PFW)
 - ▩ PERMANENT INTERTIDAL SHALLOWS IMPACT (PIS)
 - ▧ PERMANENT STATE OPEN WATER IMPACT (PSOW)
 - ▦ TEMPORARY FRESHWATER WETLAND IMPACT (TFW)
 - ▤ TEMPORARY INTERTIDAL SHALLOWS IMPACT (TIS)
 - ▣ TEMPORARY STATE OPEN WATER IMPACT (TSOW)

**NO WETLAND / OPEN WATER
IMPACTS THIS SHEET**

NEW JERSEY DEPARTMENT OF TRANSPORTATION
**USACE WATERS OF
 THE U.S. PERMIT PLANS**
 1-285 / ROUTE 42 MISSING MOVES
 CONTRACT NO. U28506041

ECOSYSTEM ENGINEERS, INC.
 CERTIFICATION OF AUTHORIZATION NO. 24024820200
 JAMES D. WERTZ, P.E.
 NEW JERSEY PROFESSIONAL ENGINEER LICENSE NO. 446800000

33
 40

E-35

MAY 06 2019



17:02:00 User: j452003 08/17/18 9755600/C:\GIS\Output\Permit\USACE_Flow\USACE\MPR72662_20.mxd

STATE OF NEW JERSEY
 N.J. HPP-265-1(03)

TOWNSHIP OF DEPTFORD
 GLOUCESTER COUNTY

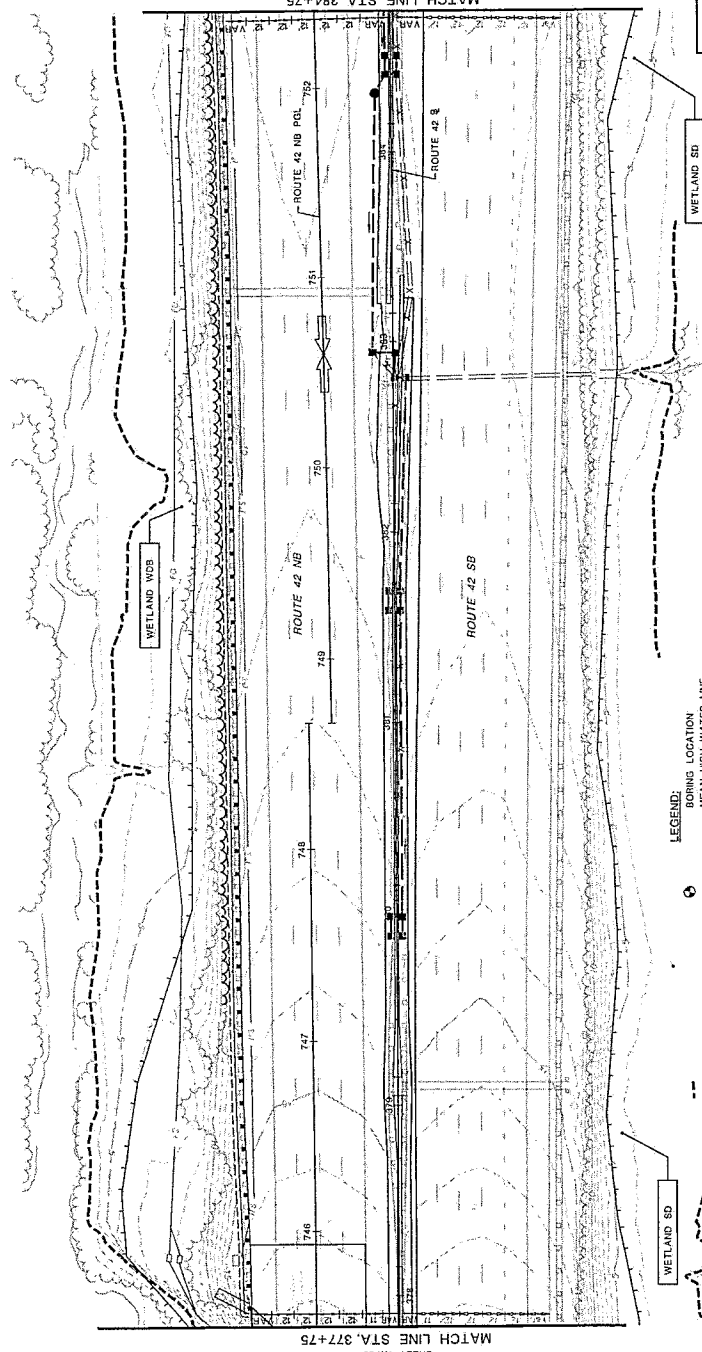
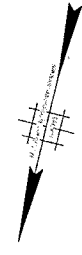

MATCH LINE STA. 377+75
 SHEET WP-30

MATCH LINE STA. 384+75
 SHEET WP-32

- LEGEND:**
- BORING LOCATION
 - MEAN HIGH WATER LINE (MHW)
 - MEAN LOW WATER LINE (MLW)
 - HIGH TIDE LINE (SPRING HIGH TIDE LINE (ELEVATION 4.33, NAVD 1988))
 - DELINEATED WETLAND LINE
 - PERMANENT FRESHWATER WETLAND IMPACT (PFWD)
 - PERMANENT INTERTIDAL SHALLOWS IMPACT (PIS)
 - PERMANENT STATE OPEN WATER IMPACT (PSOW)
 - TEMPORARY FRESHWATER WETLAND IMPACT (TFWD)
 - TEMPORARY INTERTIDAL SHALLOWS IMPACT (TIS)
 - TEMPORARY STATE OPEN WATER IMPACT (TSOW)

**NO WETLAND / OPEN WATER
 IMPACTS THIS SHEET**

NEW JERSEY DEPARTMENT OF TRANSPORTATION
 USACE WATERS OF THE U.S. PERMIT PLANS
 1205 / ROUTE 42 MISSING MOVES
 CONTRACT NO. 02B905H1

DESIGNED BY: JAMES D. KEEREN, P.E.
 CERTIFICATION OF AUTHORIZATION NO. 2403282700

34
 40



87938002-CAD/DWG/NEW/JERSEY/USACE/PA/USACE/1205/1205-21.dwg

E-36

MAY 06 2019

TOWNSHIP OF DEPTFORD
GLOUCESTER COUNTY



STATE: NJ
COUNTY: GLOUCESTER
TWP: DEPTFORD
SHEET: WP-38

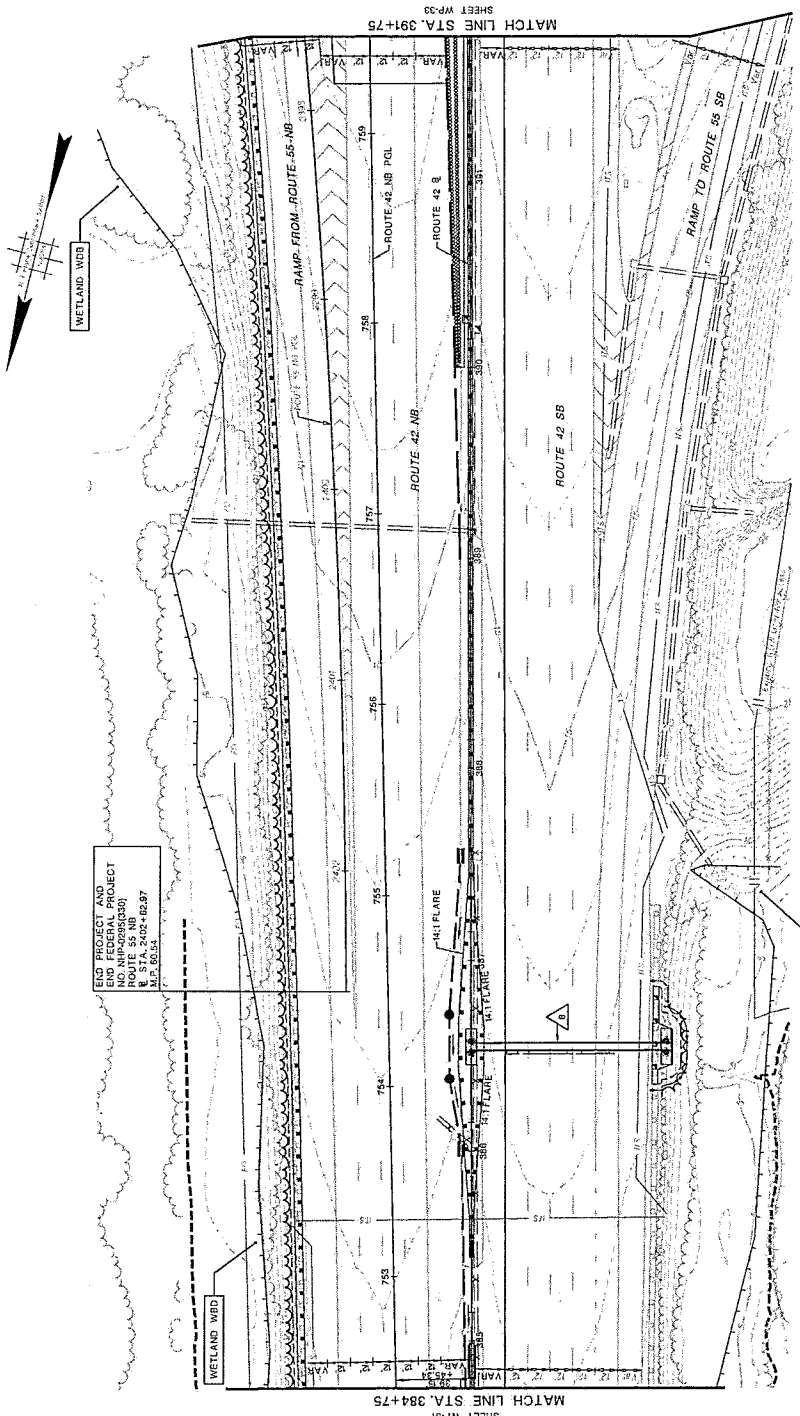

ELG PROJECT AND
EIS FEDERAL PROJECT
NO. NFP-0098(38)
DATE: 12/14/04
R. 574, 2402-8297
ALP: 60.54

MATCH LINE STA. 394+75
SHEET WP-38

MATCH LINE STA. 391+75
SHEET WP-39

- LEGEND:**
- ⊕ BORING LOCATION
 - WADING LOCATION
 - WADING LOCATION (ELEVATION 3.5' NAVD 88)
 - HIGH TIDE LINE / SPRING HIGH TIDE LINE (ELEVATION 3.0' NAVD 88)
 - DEGRADED WETLAND LINE
 - [Pattern] PERMANENT FRESHWATER WETLAND IMPACT (PFWI)
 - [Pattern] PERMANENT INTERTIDAL SHALLOWS IMPACT (PSI)
 - [Pattern] PERMANENT STATE OPEN WATER IMPACT (PSOW)
 - [Pattern] TEMPORARY FRESHWATER WETLAND IMPACT (TFWI)
 - [Pattern] TEMPORARY INTERTIDAL SHALLOWS IMPACT (TISI)
 - [Pattern] TEMPORARY STATE OPEN WATER IMPACT (TSOW)

NO WETLAND / OPEN WATER
IMPACTS THIS SHEET

WP-38
16-27

NEW JERSEY DEPARTMENT OF TRANSPORTATION
**USACE WATERS OF
THE U.S. PERMIT PLANS**
1-285 / ROUTE 42 MISSING MOVES
CONTRACT NO. 035890541

DEWBERRY ENGINEERS, INC.
CERTIFICATION OF AUTHORIZATION NO. 24025241506
JAMES D. WILSON, P.E.
NEW JERSEY PROFESSIONAL ENGINEER LICENSE NO. 24025241506
35
40



446993 06/27/06 9792600/CAD/Plan/Permit/USACE/Plan/USACE/DP72482/23.dgn

E-37

MAY 06 2019

TOWNSHIP OF DEPTFORD

GLOUCESTER COUNTY

STATE OF NEW JERSEY
M.L.L. JHP-0584(100)

30' 0' 30' 00'



UNNAMED TRIBUTARY #5

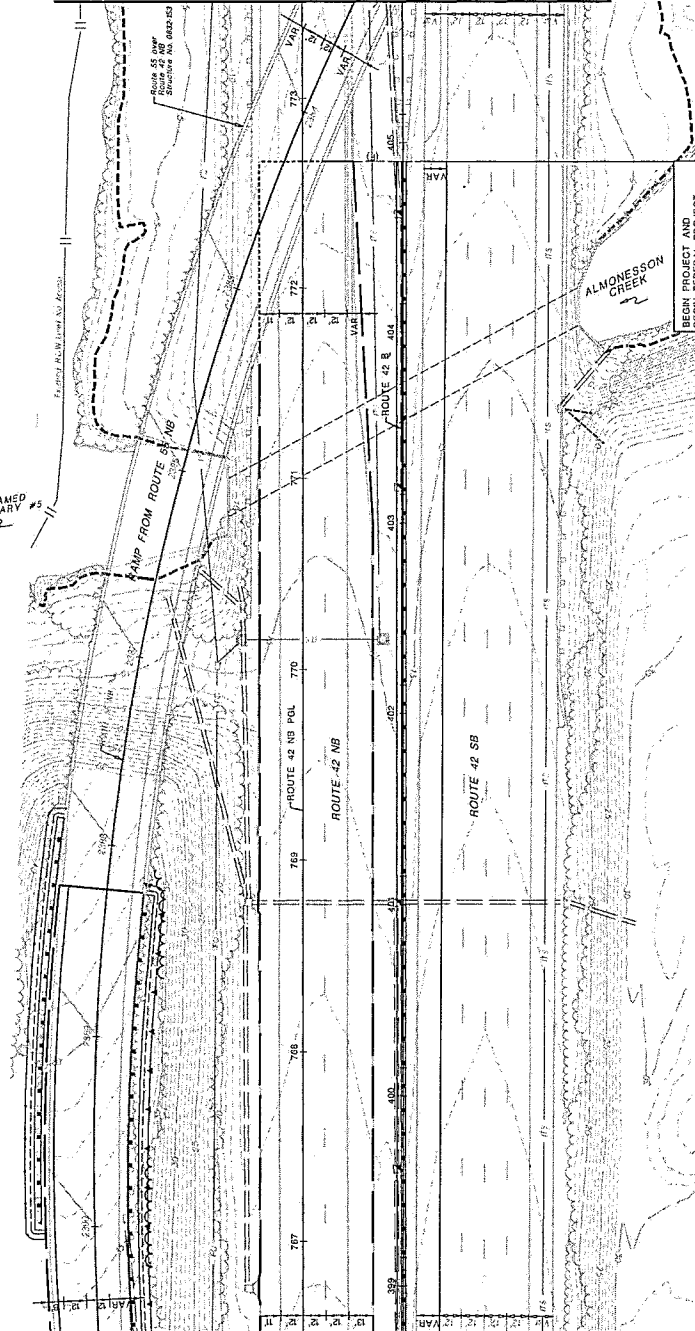

MATCH LINE STA. 398+75 SHEET WP-35

MATCH LINE STA. 408+75 SHEET WP-35

- LEGEND:**
- BORING LOCATION
 - MEAN HIGH WATER LINE (ELEVATION 3.2', NAVD 1988)
 - HIGH WATER SPRING HIGH TIDE LINE (ELEVATION 4.5', NAVD 1988)
 - DELINEATED WETLAND LINE
 - PERMANENT FRESHWATER WETLAND IMPACT (PFWI)
 - PERMANENT INTERTIDAL SHALLOWS IMPACT (PISI)
 - PERMANENT STATE OPEN WATER IMPACT (PSOWI)
 - TEMPORARY FRESHWATER WETLAND IMPACT (TFWI)
 - TEMPORARY INTERTIDAL SHALLOWS IMPACT (TISI)
 - TEMPORARY STATE OPEN WATER IMPACT (TSOWI)

NO WETLAND / OPEN WATER IMPACTS THIS SHEET

NEW JERSEY DEPARTMENT OF TRANSPORTATION

USACE WATERS OF THE U.S. PERMIT PLANS
I-295 / ROUTE 42 MISSING MOVES
CONTRACT NO. 055850541

LEWISBERY ENGINEERS INC.
CERTIFICATION OF AUTHORIZATION NO. Z4020621500

JAMES D. WERNER, P.E.
NEW JERSEY PROFESSIONAL ENGINEER LICENSE NO. Z4020621500

37 / 40



PROJECT: C:\Data\Projects\Newark\125227 - Newark\USACE\125227.dwg DATE: 08/13/2019 09:52:00

MAY 06 2019

E-39

STATE OF NEW JERSEY
N.J. IMP-354 (10)

GLOUCESTER COUNTY

TOWNSHIP OF DEPTFORD

DATE: 05/15/2019

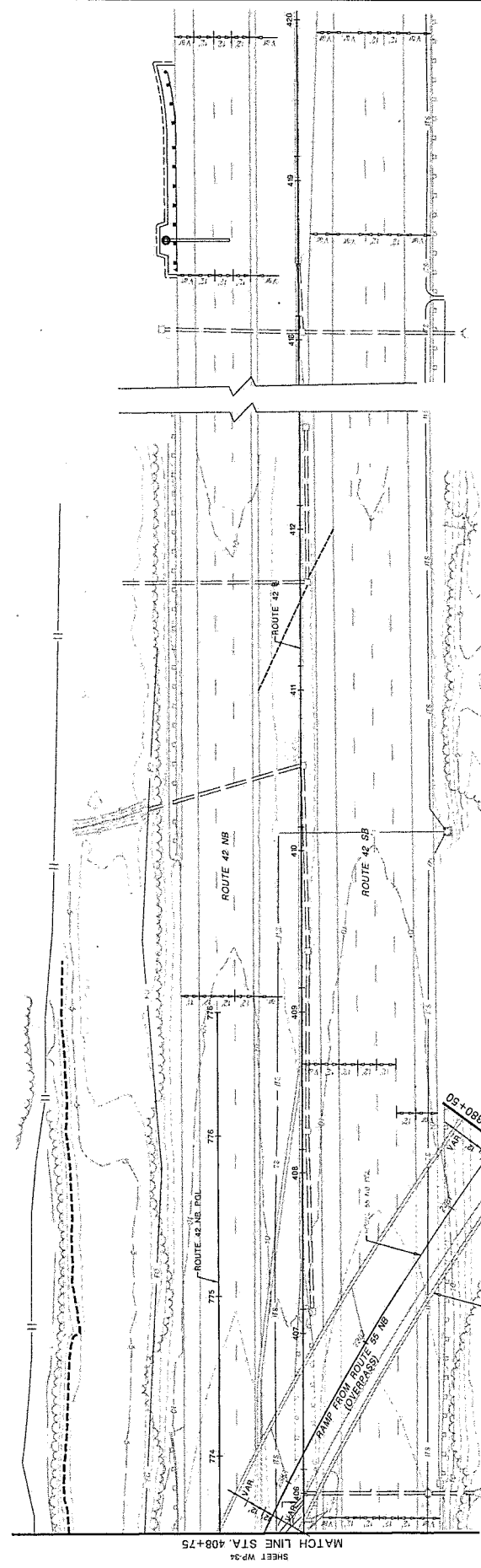
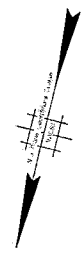

NO WETLAND / OPEN WATER IMPACTS THIS SHEET

- LEGEND:**
- BORING LOCATION
 - MEAN HIGH TIDE LINE (ELEVATION 3.27, NAVD 1988)
 - HIGH TIDE LINE / SPRING HIGH TIDE LINE (ELEVATION 4.35, NAVD 1988)
 - DELIMITED WETLAND LINE
 - PERMANENT FRESHWATER WETLAND IMPACT (PFWI)
 - PERMANENT INTERTIDAL SHALLOWS IMPACT (PISI)
 - PERMANENT STATE OPEN WATER IMPACT (PSOWI)
 - TEMPORARY FRESHWATER WETLAND IMPACT (TFWI)
 - TEMPORARY INTERTIDAL SHALLOWS IMPACT (TISI)
 - TEMPORARY STATE OPEN WATER IMPACT (TSOWI)

NEW JERSEY DEPARTMENT OF TRANSPORTATION
USACE WATERS OF THE U.S. PERMIT PLANS
 I-295 / ROUTE 42 MISSING MOVES
 CONTRACT NO. 05980541

DEWBERRY ENGINEERS, INC.
 2000 WEST 10TH STREET, SUITE 200
 NEW JERSEY PROFESSIONAL ENGINEER LICENSE NO. 246380170
 JAMES D. HEEREN, P.E.
 NEW JERSEY PROFESSIONAL ENGINEER LICENSE NO. 246380170

38
40

E-40

MAY 06 2019



97590001\CA\01\DW\Plan\Permit\USACE_Permit\USACEWP190602_30.dwg 05/15/2019 09:15:20

STATE OF NEW JERSEY
 N.J. DEP. OF TRANSPORTATION
 PROJECT NO. 1203

TOWNSHIP OF DEPTFORD
 GLOUCESTER COUNTY

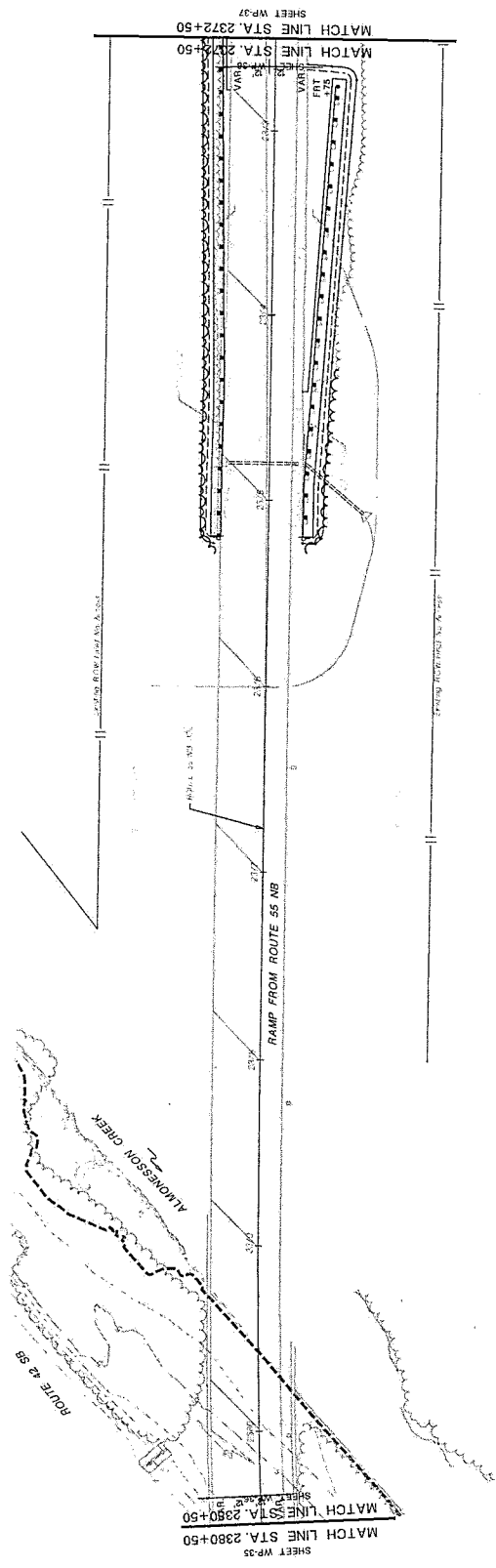
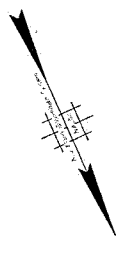

- LEGEND:**
- BORING LOCATION
 - MUDLINE (ELEVATION 3.2 NAVD 898)
 - HIGH TIDE LINE (SPRING HIGH TIDE LINE) (ELEVATION 4.33 NAVD 898)
 - DEGRADED WETLAND LINE
 - PERMANENT FRESHWATER WETLAND IMPACT (PFMW)
 - PERMANENT INTERTIDAL SHALLOWS IMPACT (RSI)
 - PERMANENT STATE OPEN WATER IMPACT (PSOW)
 - TEMPORARY FRESHWATER WETLAND IMPACT (TFW)
 - TEMPORARY INTERTIDAL SHALLOWS IMPACT (TSI)
 - TEMPORARY STATE OPEN WATER IMPACT (TSOV)

NO WETLAND / OPEN WATER IMPACTS THIS SHEET

NEW JERSEY DEPARTMENT OF TRANSPORTATION

USACE WATERS OF THE U.S. PERMIT PLANS
 1295 / ROUTE 42 MISSING MOVES
 CONTRACT NO. 025950041

GENERAL ENGINEERS, INC.
 1295 ROUTE 42, DEPTFORD, NJ 08042-2612
 JAMES D. REBERN, P.E.
 NEW JERSEY PROFESSIONAL ENGINEER LICENSE NO. 345624000

39 / 40



4/20/2019 08:48:31 925950041\CD\1295\Misc\Permit\USACE Permit\USACE\1295\12950002_2612.dwg

E-41

MAY 06 2019

ENCLOSURE 1

NOTIFICATION/CERTIFICATION OF WORK COMMENCEMENT FORM

Permit Number: CENAP-OP-R-2011-01085-95
Name of Permittee: New Jersey Department of Transportation
Project Name: Route 295/Route 42 Missing Moves Project
Waterway: Big Timber Creek/Delaware River Watershed
County: Camden & Gloucester State: New Jersey
Compensation/Mitigation Work Required: Yes No

TO: U.S. Army Corps of Engineers, Philadelphia District
Wanamaker Building – 100 Penn Square East
Philadelphia, Pennsylvania 19107-3390
Attention: CENAP-OP-R

I have received authorization to: construct the Federal Highway Administration-funded roadway improvement project known as "Route 295/Route 42 Missing Moves"; located at Big Timber Creek and the Delaware River Watershed in the Boroughs of Bellmawr and Runnemeade in Camden County, and Westville Borough and Deptford Township in Gloucester County, New Jersey.

The work will be performed by:

Name of Person or Firm: _____

Address: _____

I hereby certify that I have reviewed the approved plans, have read the terms and conditions of the above referenced permit, and shall perform the authorized work in strict accordance with the permit document. The authorized work will begin on or about _____ and should be completed on or about _____.

Please note that the permitted activity is subject to compliance inspections by the Army Corps of Engineers. If you fail to return this notification form or fail to comply with the terms or conditions of the permit, you are subject to permit suspension, modification, revocation, and/or penalties.

Permittee (Signature and Date)

Telephone Number

Contractor (Signature and Date)

Telephone Number

NOTE: This form shall be completed/signed and returned to the Philadelphia District Office prior to commencing work.

ENCLOSURE 2

NOTIFICATION/CERTIFICATION OF WORK COMPLETION/COMPLIANCE FORM

Permit Number: CENAP-OP-R-2011-01085-95
Name of Permittee: New Jersey Department of Transportation
Name of Contractor: _____
Project Name: Route 295/Route 42 Missing Moves Project
County: Camden & Gloucester State: New Jersey
Waterway: Big Timber Creek/Delaware River Watershed

Within 10 days of completion of the activity authorized by this permit, please sign this certification and return it to the following address:

U.S. Army Corps of Engineers, Philadelphia District
Wanamaker Building - 100 Penn Square East
Philadelphia, Pennsylvania 19107-3390
Attention: CENAP-OP-R

Please note that the permitted activity is subject to a compliance inspection by an Army Corps of Engineers representative. If you fail to return this notification form or fail to perform work in compliance with the permit, you are subject to administrative, civil and/or criminal penalties. Further, the subject permit may be suspended or revoked.

The authorized work was commenced on _____.

The authorized work was completed on _____.

I hereby certify that the work authorized by the above referenced permit has been completed in accordance with the terms and conditions of the above noted permit.

Signature of Contractor

Signature of Permittee

Address: _____

Address: _____

Telephone Number: _____

Telephone Number: _____

For project located in areas identified as shellfish habitat, you must include with this form a bill of lading; sales order or any other document(s) demonstrating non-polluting materials were purchased and utilized for your project. I hereby certify that I and/or my contractor have utilized non-polluting materials as defined in the above noted permit.

Signature of Contractor

Signature of Permittee

ENCLOSURE 3